

AGENDA FOR

LICENSING HEARING PANEL

Contact: Andrea Tomlinson
Direct Line: 0161 253 5133
E-mail: a.j.tomlinson@bury.gov.uk
Web Site: www.bury.gov.uk

To: All Members of Licensing Hearing Panel

Councillors : J Grimshaw, T Holt (Chair) and I Schofield

Dear Member/Colleague

Licensing Hearing Panel

You are invited to attend a meeting of the Licensing Hearing Panel which will be held as follows:-

Date:	Monday, 14 September 2020
Place:	Microsoft Teams
Time:	1.00 pm
Briefing Facilities:	If Opposition Members and Co-opted Members require briefing on any particular item on the Agenda, the appropriate Director/Senior Officer originating the related report should be contacted.
Notes:	

AGENDA

1 APOLOGIES FOR ABSENCE

2 DECLARATIONS OF INTEREST

Members of the Licensing Hearings Panel are asked to consider whether they have an interest in any matter on the agenda, and, if so, to formally declare that interest.

3 APPLICATION FOR A PREMISES LICENCE TO BE GRANTED UNDER THE LICENSING ACT 2003 IN RESPECT OF MYLES TRADING, 2A THE PARADE, RUFFORD DRIVE, WHITEFIELD M45 8PL (Pages 1 - 108)

Report from the Executive Director (Operations) is attached
Application and Plan attached
Appendix 2 (2 Docs) is attached

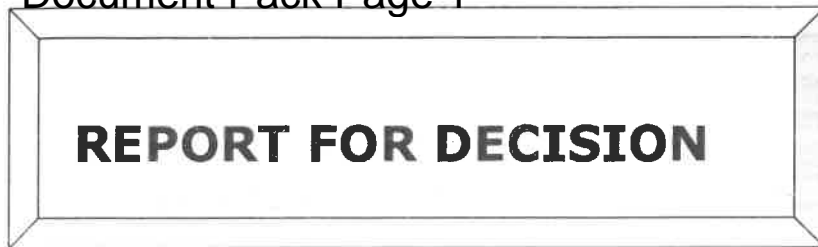

DECISION OF:	LICENSING HEARINGS PANEL
DATE:	14th SEPTEMBER 2020
SUBJECT:	APPLICATION FOR A PREMISES LICENCE TO BE GRANTED UNDER THE LICENSING ACT 2003 IN RESPECT OF MYLES TRADING, 2A THE PARADE, RUFFORD DRIVE, WHITEFIELD, M45 8PL
REPORT FROM:	EXECUTIVE DIRECTOR (OPERATIONS)
CONTACT OFFICER:	MR M BRIDGE
TYPE OF DECISION:	COUNCIL
FREEDOM OF INFORMATION/STATUS:	This paper is within the public domain
SUMMARY:	This report relates to an application for a Premises Licence to be granted under the Licensing Act 2003 in respect of Myles Trading, 2A The Parade, Rufford Drive, Whitefield, M45 8PL in respect of which representations have been received.
OPTIONS & RECOMMENDED OPTION	<ul style="list-style-type: none"> • To grant the application in the terms requested • To grant the application subject to conditions • To amend or modify existing or proposed conditions • To refuse the application
IMPLICATIONS:	
Corporate Aims/Policy Framework:	Do the proposals accord with the Policy Framework? Yes No
Statement by the S151 Officer: Financial Implications and Risk Considerations:	There are no specific issues from the report other than potential costs/risks associated with legal appeals
Statement by Executive Director of Resources:	The cost of the licensing function are funded through the fees and charges levied by the Council. There may be additional costs if appeals are lodged with the Magistrates and Crown Courts.

Equality/Diversity implications:	Yes No (see paragraph below)
Considered by Monitoring Officer:	Under the legislation the Council is required to determine representations. The report is in accordance with the appropriate legislation.
Wards Affected:	Unsworth
Scrutiny Interest:	Internal Scrutiny Panel

TRACKING/PROCESS

DIRECTOR:

Chief Executive/ Strategic Leadership Team	Executive Member/Chair	Ward Members	Partners
Scrutiny Committee	Committee	Council	

1.0 BACKGROUND

- 1.1 The Licensing Act 2003 and the Licensing Act 2003 (Hearings) Regulations is the relevant legislation.
- 1.2 The Panel will make a decision on the day of the hearing and the parties will be notified subsequently of the decision and the reasons for it by letter from the Licensing Office.

2.0 BACKGROUND

- 2.1 The applicant for the licence in respect of the above premises is Mr Lijo Thomas, 13 Evesham Walk, Middleton, M24 1PW. Mr Thomas is also the proposed Designated Premises Supervisor (DPS).
- 2.2 The applicant has complied with all the necessary procedural requirements laid down by the Act.
- 2.3 As part of the statutory process the Responsible Authorities and interested parties are entitled to make representations in relation to the grant of a licence. Where representations are made and not withdrawn Members are required to determine them.
- 2.4 Representations must be relevant to the licensing objectives defined within the Act. The objectives are:-
 - the prevention of crime and disorder
 - public safety
 - prevention of public nuisance and
 - protection of children from harm

3.0 THE APPLICATION

3.1 The application is for the grant of a Premises Licence under Part 3 of the Licensing Act 2003:

The operating schedule shows the following:

- a. Supply of alcohol – For consumption Off the Premises only.
Monday to Sunday 07.00 until 23.00
- b. Opening Times.
Monday to Sunday 07.00 until 23.00

4.0 OTHER REPRESENTATIONS

All the representations were received before the end of the objection period.

4.1 One interested party has made a relevant representation to this application are detailed below:-

- Will cause disruption
- Anti-social behaviour of patrons

4.2 The Licensing Authority have received 73 individual letters in support of the application

4.3 These representations are attached at Appendix 2.

5.0 OBSERVATIONS

5.1 After hearing the representations made and the evidence presented, Members are obliged to determine the application with a view to promoting the licensing objectives and having regard to the Authority's Licensing Policy and National Guidance.

List of Background Papers:-

Application form
Representation received
Plan

For further information on the details of this report, please contact:

Mr M Bridge
Licensing Office
3 Knowsley Place
Duke Street
Bury
Telephone No: 0161 253 5208
Email: m.bridge@bury.gov.uk

Application for a new premises licence

Myles Local, 2a The Parade, Rufford Drive, Whitefield, Bury M45 8PL

Operating schedule/proposed licence conditions

Introduction

This is a small and well-established shop situated within a parade of various shops currently trading as a convenience store/post office selling a range of goods including groceries, soft drinks, cigarettes, dairy goods, newspapers etc.

The applicant (new owner) would just like to add some alcohol sales to allow the business to develop and offer the complete all-round convenience service. The focus of the shop will continue as a general convenience store with the proposed alcohol sales would just be a small part of the overall business.

A detailed and robust operating schedule is proposed to promote the licensing objectives;

Prevention of crime and disorder

A CCTV camera system capable of providing evidential quality images in all lighting conditions shall be used covering the interior and the immediate exterior (entrance) of the shop. Images will be retained for a period of at least 28 days and be made available to the Police upon request within a reasonable time period.

A staff training scheme shall be used for all staff authorised to sell alcohol. The training will cover the importance of preventing under age sales and complying with licence conditions. Refresher training will be provided every 12 months, records will be kept and be made available to responsible authorities

All staff selling alcohol shall be authorised to sell alcohol in writing and a record of the authorisation will be kept in the shop for inspection.

The PLH and staff will be vigilant and monitor the area immediately outside the shop to check that youths do not cause annoyance by congregating.

Spirits will be kept behind the counter.

Document Pack Page 5

Any incidents of crime and disorder at or immediately outside the premises, witnessed by staff, will be recorded in an incident book kept at the premises. This book will be kept in the shop and available for inspection.

The premises shall operate a strict alcohol refusals policy - alcohol will not be sold to;

- (1) Any person recognised or identified as a street drinker (regardless of their level of inebriation at the time);
- (2) Any person found to be drinking alcohol in the street;
- (3) Any person who is drunk or appears to be drunk;
- (4) Any person suspected of trying to buy alcohol for another person who is drunk or appears to be drunk;
- (5) Any person unable to provide valid ID when requested by staff;
- (6) Any person who is verbally or physically abusive towards staff or customers.
- (7) To any person suspected of trying to buy alcohol for another person(s) who may be under age.

A notice advising customers of the refusals policy shall be on display.

'Crimestoppers' promotional material will be on display to promote the initiative.

Public safety

Appropriate fire safety equipment to be available, and the PLH shall comply with other legislative requirements to ensure that the shop is safe for customers and staff.

Prevention of public nuisance

Deliveries to the premises will be arranged so as not to cause will not lead to any public nuisance.

Notices shall be on display in the premises asking customers to leave the premises quietly.

Staff will monitor the area immediately outside the premises on a regular basis to check for, and to properly dispose of, any litter from the premises.

Protection of children from harm

The PLH shall ensure that anyone who appears to be under 25 years old who attempts to purchase alcohol will be asked to prove their age by producing an acceptable form of photographic ID such as a passport, photo driving licence, military ID and PASS accredited proof of age cards.

A refusals register (for the sale of alcohol) will be kept and be available for inspection by responsible authorities.

Notices shall be displayed in the premises where they can be seen clearly to advise customers that it is unlawful for persons under 18 to purchase alcohol or for any persons to purchase alcohol on behalf of a person under 18 years of age.

** Amended copy **



Bury
Application for a premises licence
Licensing Act 2003

For help contact
licensing@bury.gov.uk
Telephone: 0161 253 5208

* required information

Section 1 of 21

You can save the form at any time and resume it later. You do not need to be logged in when you resume.

System reference	Not Currently In Use	This is the unique reference for this application generated by the system.
Your reference		You can put what you want here to help you track applications if you make lots of them. It is passed to the authority.

Are you an agent acting on behalf of the applicant?

Yes No

Put "no" if you are applying on your own behalf or on behalf of a business you own or work for.

Applicant Details

* First name	LIJO	*
* Family name	THOMAS	
* E-mail	ijrushy@hotmail.com	
Main telephone number		Include country code.
Other telephone number		

Indicate here if the applicant would prefer not to be contacted by telephone

Is the applicant:

<input type="radio"/> Applying as a business or organisation, including as a sole trader	A sole trader is a business owned by one person without any special legal structure. Applying as an individual means the applicant is applying so the applicant can be employed, or for some other personal reason, such as following a hobby.
<input checked="" type="radio"/> Applying as an individual	

Continued from previous page...

Address

* Building number or name

* Street

District

* City or town

County or administrative area

* Postcode

* Country

Agent Details

* First name

* Family name

* E-mail

Main telephone number Include country code.

Other telephone number

Indicate here if you would prefer not to be contacted by telephone

Are you:

- An agent that is a business or organisation, including a sole trader
- A private individual acting as an agent

A sole trader is a business owned by one person without any special legal structure.

Agent Business

Is your business registered in the UK with Companies House? Yes No

Note: completing the Applicant Business section is optional in this form.

Is your business registered outside the UK? Yes No

Business name

VAT number

Legal status

Your position in the business

Home country

If your business is registered, use its registered name.

Put "none" if you are not registered for VAT.

The country where the headquarters of your business is located.

Continued from previous page...

Agent Business Address

If you have one, this should be your official address - that is an address required of you by law for receiving communications.

Building number or name	77
Street	WOMACK GARDENS
District	
City or town	ST HELENS
County or administrative area	MERSEYSIDE
Postcode	WA9 5UT
Country	United Kingdom

Section 2 of 21

PREMISES DETAILS

I/we, as named in section 1, apply for a premises licence under section 17 of the Licensing Act 2003 for the premises described in section 2 below (the premises) and I/we are making this application to you as the relevant licensing authority in accordance with section 12 of the Licensing Act 2003.

Premises Address

Are you able to provide a postal address, OS map reference or description of the premises?

- Address
 OS map reference
 Description

Postal Address Of Premises

Building number or name	MYLES TRADING
Street	2A THE PARADE, RUFFORD DRIVE
District	WHITEFIELD
City or town	
County or administrative area	BURY
Postcode	M45 8PL
Country	United Kingdom

Further Details

Telephone number	
Non-domestic rateable value of premises (£)	5,700

Section 3 of 21

APPLICATION DETAILS

In what capacity are you applying for the premises licence?

- An individual or individuals
- A limited company / limited liability partnership
- A partnership (other than limited liability)
- An unincorporated association
- Other (for example a statutory corporation)
- A recognised club
- A charity
- The proprietor of an educational establishment
- A health service body
- A person who is registered under part 2 of the Care Standards Act 2000 (c14) in respect of an independent hospital in Wales
- A person who is registered under Chapter 2 of Part 1 of the Health and Social Care Act 2008 in respect of the carrying on of a regulated activity (within the meaning of that Part) in an independent hospital in England
- The chief officer of police of a police force in England and Wales

Confirm The Following

- I am carrying on or proposing to carry on a business which involves the use of the premises for licensable activities
- I am making the application pursuant to a statutory function
- I am making the application pursuant to a function discharged by virtue of Her Majesty's prerogative

Section 4 of 21

INDIVIDUAL APPLICANT DETAILS

Applicant Name

Is the name the same as (or similar to) the details given in section one?

- Yes No

If "Yes" is selected you can re-use the details from section one, or amend them as required. Select "No" to enter a completely new set of details.

First name

Family name

Is the applicant 18 years of age or older?

- Yes No

Continued from previous page...

Current Residential Address

Is the address the same as (or similar to) the address given in section one?

- Yes
- No

If "Yes" is selected you can re-use the details from section one, or amend them as required. Select "No" to enter a completely new set of details.

Building number or name	13
Street	EVESHAM WALK
District	MIDDLETON
City or town	MANCHESTER
County or administrative area	
Postcode	M24 1PW
Country	United Kingdom

Applicant Contact Details

Are the contact details the same as (or similar to) those given in section one?

- Yes
- No

If "Yes" is selected you can re-use the details from section one, or amend them as required. Select "No" to enter a completely new set of details.

E-mail	ijrushy@hotmail.com
Telephone number	
Other telephone number	
* Date of birth	05 / 05 / 1978 dd mm yyyy
* Nationality	BRITISH CITIZEN
Right to work share code	

Documents that demonstrate entitlement to work in the UK
Right to work share code if not submitting scanned documents

Add another applicant

Section 5 of 21

OPERATING SCHEDULE

When do you want the premises licence to start? / /
dd mm yyyy

If you wish the licence to be valid only for a limited period, when do you want it to end / /
dd mm yyyy

Provide a general description of the premises

Continued from previous page...

For example the type of premises, its general situation and layout and any other information which could be relevant to the licensing objectives. Where your application includes off-supplies of alcohol and you intend to provide a place for consumption of these off-supplies you must include a description of where the place will be and its proximity to the premises.

THIS IS A SMALL AND WELL-ESTABLISHED GENERAL CONVENIENCE STORE AND POST OFFICE SERVING THE LOCAL COMMUNITY SELLING A RANGE OF GOODS SUCH AS NEWSPAPERS, MAGAZINES, BREAD, DAIRY, SWEETS, CIGARETTES, SOFT DRINKS, ETC.

THE SHOP IS LOCATED WITHIN A PARADE OF SHOPS INCLUDING A SALON, A CONVENIENCE STORE, AND SEVERAL TAKEAWAYS.

THE APPLICANT HAS RECENTLY INVESTED AND TAKEN OVER THE BUSINESS AND WOULD LIKE TO DEVELOP IT BY ADDING SOME ALCOHOL SALES. THE PROPOSED ALCOHOL SALES WOULD JUST BE A PART OF THE OVERALL BUSINESS TO OFFER CUSTOMERS THE COMPLETE ALL-ROUND CONVENIENCE SERVICE.

THE POLICE HAVE BEEN CONSULTED IN ADVANCE OF SUBMITTING THE APPLICATION AND REPORT NO ISSUES.

ALCOHOL WOULD BE KEPT TOWARDS THE REAR OF THE SHOP, AWAY FROM THE ENTRANCE.

THE SHOP (WITH A LICENCE) WOULD BE WELL MANAGED AND A COMPREHENSIVE AND ROBUST OPERATING SCHEDULE IS PROPOSED TO PROMOTE THE LICENSING OBJECTIVES.

If 5,000 or more people are expected to attend the premises at any one time, state the number expected to attend

Section 6 of 21

PROVISION OF PLAYS

See guidance on regulated entertainment

Will you be providing plays?

- Yes No

Section 7 of 21

PROVISION OF FILMS

See guidance on regulated entertainment

Will you be providing films?

- Yes No

Section 8 of 21

PROVISION OF INDOOR SPORTING EVENTS

See guidance on regulated entertainment

Will you be providing indoor sporting events?

- Yes No

Section 9 of 21

PROVISION OF BOXING OR WRESTLING ENTERTAINMENTS

See guidance on regulated entertainment

Continued from previous page...

Will you be providing boxing or wrestling entertainments?

Yes No

Section 10 of 21

PROVISION OF LIVE MUSIC

See guidance on regulated entertainment

Will you be providing live music?

Yes No

Section 11 of 21

PROVISION OF RECORDED MUSIC

See guidance on regulated entertainment

Will you be providing recorded music?

Yes No

Section 12 of 21

PROVISION OF PERFORMANCES OF DANCE

See guidance on regulated entertainment

Will you be providing performances of dance?

Yes No

Section 13 of 21

PROVISION OF ANYTHING OF A SIMILAR DESCRIPTION TO LIVE MUSIC, RECORDED MUSIC OR PERFORMANCES OF DANCE

See guidance on regulated entertainment

Will you be providing anything similar to live music, recorded music or performances of dance?

Yes No

Section 14 of 21

LATE NIGHT REFRESHMENT

Will you be providing late night refreshment?

Yes No

Section 15 of 21

SUPPLY OF ALCOHOL

Will you be selling or supplying alcohol?

Yes No

Standard Days And Timings

MONDAY

Start End

Start End

Give timings in 24 hour clock. (e.g., 16:00) and only give details for the days of the week when you intend the premises to be used for the activity.

Continued from previous page...

TUESDAY

Start	<input type="text" value="07:00"/>	End	<input type="text" value="23:00"/>
Start	<input type="text"/>	End	<input type="text"/>

WEDNESDAY

Start	<input type="text" value="07:00"/>	End	<input type="text" value="23:00"/>
Start	<input type="text"/>	End	<input type="text"/>

THURSDAY

Start	<input type="text" value="07:00"/>	End	<input type="text" value="23:00"/>
Start	<input type="text"/>	End	<input type="text"/>

FRIDAY

Start	<input type="text" value="07:00"/>	End	<input type="text" value="23:00"/>
Start	<input type="text"/>	End	<input type="text"/>

SATURDAY

Start	<input type="text" value="07:00"/>	End	<input type="text" value="23:00"/>
Start	<input type="text"/>	End	<input type="text"/>

SUNDAY

Start	<input type="text" value="07:00"/>	End	<input type="text" value="23:00"/>
Start	<input type="text"/>	End	<input type="text"/>

Will the sale of alcohol be for consumption:

- On the premises
 Off the premises
 Both

If the sale of alcohol is for consumption on the premises select on, if the sale of alcohol is for consumption away from the premises select off. If the sale of alcohol is for consumption on the premises and away from the premises select both.

State any seasonal variations

For example (but not exclusively) where the activity will occur on additional days during the summer months.

Non-standard timings. Where the premises will be used for the supply of alcohol at different times from those listed in the column on the left, list below

For example (but not exclusively), where you wish the activity to go on longer on a particular day e.g. Christmas Eve.

Continued from previous page...

State the name and details of the individual whom you wish to specify on the licence as premises supervisor

Name

First name

Family name

Date of birth / /
dd mm yyyy

Enter the contact's address

Building number or name

Street

District

City or town

County or administrative area

Postcode

Country

Personal Licence number (if known)

Issuing licensing authority (if known)

PROPOSED DESIGNATED PREMISES SUPERVISOR CONSENT

How will the consent form of the proposed designated premises supervisor be supplied to the authority?

- Electronically, by the proposed designated premises supervisor
- As an attachment to this application

Reference number for consent form (if known)

If the consent form is already submitted, ask the proposed designated premises supervisor for its 'system reference' or 'your reference'.

Section 16 of 21

ADULT ENTERTAINMENT

Highlight any adult entertainment or services, activities, or other entertainment or matters ancillary to the use of the premises that may give rise to concern in respect of children

Give information about anything intended to occur at the premises or ancillary to the use of the premises which may give rise to concern in respect of children, regardless of whether you intend children to have access to the premises, for example (but not exclusively) nudity or semi-nudity, films for restricted age groups etc gambling machines etc.

Continued from previous page...

Section 17 of 21

HOURS PREMISES ARE OPEN TO THE PUBLIC

Standard Days And Timings

MONDAY

Start

End

Start

End

Give timings in 24 hour clock.
(e.g., 16:00) and only give details for the days
of the week when you intend the premises
to be used for the activity.

TUESDAY

Start

End

Start

End

WEDNESDAY

Start

End

Start

End

THURSDAY

Start

End

Start

End

FRIDAY

Start

End

Start

End

SATURDAY

Start

End

Start

End

SUNDAY

Start

End

Start

End

State any seasonal variations

For example (but not exclusively) where the activity will occur on additional days during the summer months.

Continued from previous page...

Non standard timings. Where you intend to use the premises to be open to the members and guests at different times from those listed in the column on the left, list below

For example (but not exclusively), where you wish the activity to go on longer on a particular day e.g. Christmas Eve.

Section 18 of 21

LICENSING OBJECTIVES

Describe the steps you intend to take to promote the four licensing objectives:

a) General – all four licensing objectives (b,c,d,e)

List here steps you will take to promote all four licensing objectives together.

SEE ATTACHED

b) The prevention of crime and disorder

SEE ATTACHED

c) Public safety

SEE ATTACHED

d) The prevention of public nuisance

SEE ATTACHED

e) The protection of children from harm

SEE ATTACHED

Section 19 of 21

NOTES ON DEMONSTRATING ENTITLEMENT TO WORK IN THE UK

Continued from previous page...

Entitlement to work/immigration status for individual applicants and applications from partnerships which are not limited liability partnerships:

A licence may not be held by an individual or an individual in a partnership who is resident in the UK who:

- does not have the right to live and work in the UK; or
- is subject to a condition preventing him or her from doing work relating to the carrying on of a licensable activity.

Any premises licence issued in respect of an application made on or after 6 April 2017 will become invalid if the holder ceases to be entitled to work in the UK.

Applicants must demonstrate that they have an entitlement to work in the UK and are not subject to a condition preventing them from doing work relating to the carrying on of a licensable activity. They do this in one of two ways: 1) by providing with this application copies or scanned copies of the documents listed below (which do not need to be certified), or 2) by providing their 'share code' to enable the licensing authority to carry out a check using the Home Office online right to work checking service (see below).

Documents which demonstrate entitlement to work in the UK

- An expired or current passport showing the holder, or a person named in the passport as the child of the holder, is a British citizen or a citizen of the UK and Colonies having the right of abode in the UK [please see note below about which sections of the passport to copy].
- An expired or current passport or national identity card showing the holder, or a person named in the passport as the child of the holder, is a national of a European Economic Area country or Switzerland.
- A Registration Certificate or document certifying permanent residence issued by the Home Office to a national of a European Economic Area country or Switzerland.
- A Permanent Residence Card issued by the Home Office to the family member of a national of a European Economic Area country or Switzerland.
- A **current** Biometric Immigration Document (Biometric Residence Permit) issued by the Home Office to the holder indicating that the person named is allowed to stay indefinitely in the UK, or has no time limit on their stay in the UK.
- A **current** passport endorsed to show that the holder is exempt from immigration control, is allowed to stay indefinitely in the UK, has the right of abode in the UK, or has no time limit on their stay in the UK.
- A **current** Immigration Status Document issued by the Home Office to the holder with an endorsement indicating that the named person is allowed to stay indefinitely in the UK or has no time limit on their stay in the UK, **when produced in combination with** an official document giving the person's permanent National Insurance number and their name issued by a Government agency or a previous employer.
- A birth or adoption certificate issued in the UK, **when produced in combination with** an official document giving the person's permanent National Insurance number and their name issued by a Government agency or a previous employer.
- A birth or adoption certificate issued in the Channel Islands, the Isle of Man or Ireland **when produced in combination with** an official document giving the person's permanent National Insurance number and their name issued by a Government agency or a previous employer.
- A certificate of registration or naturalisation as a British citizen, **when produced in combination with** an official document giving the person's permanent National Insurance number and their name issued by a Government agency or a previous employer.

Continued from previous page...

- A **current** passport endorsed to show that the holder is allowed to stay in the UK and is currently allowed to work and is not subject to a condition preventing the holder from doing work relating to the carrying on of a licensable activity.
- A **current** Biometric Immigration Document (Biometric Residence Permit) issued by the Home Office to the holder which indicates that the named person can currently stay in the UK and is allowed to work relation to the carrying on of a licensable activity.
- A **current** Residence Card issued by the Home Office to a person who is not a national of a European Economic Area state or Switzerland but who is a family member of such a national or who has derivative rights or residence.
- A **current** Immigration Status Document containing a photograph issued by the Home Office to the holder with an endorsement indicating that the named person may stay in the UK, and is allowed to work and is not subject to a condition preventing the holder from doing work relating to the carrying on of a licensable activity **when produced in combination with** an official document giving the person's permanent National Insurance number and their name issued by a Government agency or a previous employer.
- A Certificate of Application, **less than 6 months old**, issued by the Home Office under regulation 18(3) or 20(2) of the Immigration (European Economic Area) Regulations 2016, to a person who is not a national of a European Economic Area state or Switzerland but who is a family member of such a national or who has derivative rights of residence.
- Reasonable evidence that the person has an outstanding application to vary their permission to be in the UK with the Home Office such as the Home Office acknowledgement letter or proof of postage evidence, or reasonable evidence that the person has an appeal or administrative review pending on an immigration decision, such as an appeal or administrative review reference number.
- Reasonable evidence that a person who is not a national of a European Economic Area state or Switzerland but who is a family member of such a national or who has derivative rights of residence in exercising treaty rights in the UK including:-
 - evidence of the applicant's own identity – such as a passport,
 - evidence of their relationship with the European Economic Area family member – e.g. a marriage certificate, civil partnership certificate or birth certificate, and
 - evidence that the European Economic Area national has a right of permanent residence in the UK or is one of the following if they have been in the UK for more than 3 months:
 - (i) working e.g. employment contract, wage slips, letter from the employer,
 - (ii) self-employed e.g. contracts, invoices, or audited accounts with a bank,
 - (iii) studying e.g. letter from the school, college or university and evidence of sufficient funds; or
 - (iv) self-sufficient e.g. bank statements.

Family members of European Economic Area nationals who are studying or financially independent must also provide evidence that the European Economic Area national and any family members hold comprehensive sickness insurance in the UK. This can include a private medical insurance policy, an EHIC card or an S1, S2 or S3 form.

Original documents must not be sent to licensing authorities. If the document copied is a passport, a copy of the following pages should be provided:-

- (i) any page containing the holder's personal details including nationality;
- (ii) any page containing the holder's photograph;
- (iii) any page containing the holder's signature;
- (iv) any page containing the date of expiry; and
- (v) any page containing information indicating the holder has permission to enter or remain in the UK and is permitted to work.

Continued from previous page...

If the document is not a passport, a copy of the whole document should be provided.

Your right to work will be checked as part of your licensing application and this could involve us checking your immigration status with the Home Office. We may otherwise share information with the Home Office. Your licence application will not be determined until you have complied with this guidance.

Home Office online right to work checking service

As an alternative to providing a copy of the documents listed above, applicants may demonstrate their right to work by allowing the licensing authority to carry out a check with the Home Office online right to work checking service.

To demonstrate their right to work via the Home Office online right to work checking service, applicants should try to find an employer or sponsor who can provide a share code. The share code is a unique code that can be used to access the Home Office online right to work checking service. Applicants should contact their employer or sponsor for more information.

In order to establish the applicant's right to work, the check will need to indicate that the applicant is allowed to work in the United Kingdom and is not subject to a condition preventing them from doing work relating to the carrying on of a licensable activity.

An online check will not be possible in all circumstances because not all applicants will have an immigration status that can be checked online. The Home Office online right to work checking service sets out what information and/or documentation applicants will need in order to access the service. Applicants who are unable to obtain a share code from the service should submit copy documents as set out above.

Section 20 of 21

NOTES ON REGULATED ENTERTAINMENT

Continued from previous page...

In terms of specific **regulated entertainments** please note that:

- Plays: no licence is required for performances between 08:00 and 23.00 on any day, provided that the audience does not exceed 500.
- Films: no licence is required for 'not-for-profit' film exhibition held in community premises between 08.00 and 23.00 on any day provided that the audience does not exceed 500 and the organiser (a) gets consent to the screening from a person who is responsible for the premises; and (b) ensures that each such screening abides by age classification ratings.
- Indoor sporting events: no licence is required for performances between 08.00 and 23.00 on any day, provided that the audience does not exceed 1000.
- Boxing or Wrestling Entertainment: no licence is required for a contest, exhibition or display of Greco-Roman wrestling, or freestyle wrestling between 08.00 and 23.00 on any day, provided that the audience does not exceed 1000. Combined fighting sports – defined as a contest, exhibition or display which combines boxing or wrestling with one or more martial arts – are licensable as a boxing or wrestling entertainment rather than an indoor sporting event.
- Live music: no licence permission is required for:
 - o a performance of unamplified live music between 08.00 and 23.00 on any day, on any premises.
 - o a performance of amplified live music between 08.00 and 23.00 on any day on premises authorised to sell alcohol for consumption on those premises, provided that the audience does not exceed 500.
 - o a performance of amplified live music between 08.00 and 23.00 on any day, in a workplace that is not licensed to sell alcohol on those premises, provided that the audience does not exceed 500.
 - o a performance of amplified live music between 08.00 and 23.00 on any day, in a church hall, village hall, community hall, or other similar community premises, that is not licensed by a premises licence to sell alcohol, provided that (a) the audience does not exceed 500, and (b) the organiser gets consent for the performance from a person who is responsible for the premises.
 - o a performance of amplified live music between 08.00 and 23.00 on any day, at the non-residential premises of (i) a local authority, or (ii) a school, or (iii) a hospital, provided that (a) the audience does not exceed 500, and (b) the organiser gets consent for the performance on the relevant premises from: (i) the local authority concerned, or (ii) the school or (iii) the health care provider for the hospital.
- Recorded Music: no licence permission is required for:
 - o any playing of recorded music between 08.00 and 23.00 on any day on premises authorised to sell alcohol for consumption on those premises, provided that the audience does not exceed 500.
 - o any playing of recorded music between 08.00 and 23.00 on any day, in a church hall, village hall, community hall, or other similar community premises, that is not licensed by a premises licence to sell alcohol, provided that (a) the audience does not exceed 500, and (b) the organiser gets consent for the performance from a person who is responsible for the premises.
 - o any playing of recorded music between 08.00 and 23.00 on any day, at the non-residential premises of (i) a local authority, or (ii) a school, or (iii) a hospital, provided that (a) the audience does not exceed 500, and (b) the organiser gets consent for the performance on the relevant premises from: (i) the local authority concerned, or (ii) the school proprietor or (iii) the health care provider for the hospital.

Continued from previous page...

- Dance: no licence is required for performances between 08.00 and 23.00 on any day, provided that the audience does not exceed 500. However, a performance which amounts to adult entertainment remains licensable.

- Cross activity exemptions: no licence is required between 08.00 and 23.00 on any day; with no limit on audience size for:

- o any entertainment taking place on the premises of the local authority where the entertainment is provided by or on behalf of the local authority;
- o any entertainment taking place on the hospital premises of the health care provider where the entertainment is provided by or on behalf of the health care provider;
- o any entertainment taking place on the premises of the school where the entertainment is provided by or on behalf of the school proprietor; and
- o any entertainment (excluding films and a boxing or wrestling entertainment) taking place at a travelling circus, provided that (a) it takes place within a moveable structure that accommodates the audience, and (b) that the travelling circus has not been located on the same site for more than 28 consecutive days.

Section 21 of 21

PAYMENT DETAILS

This fee must be paid to the authority. If you complete the application online, you must pay it by debit or credit card.

Premises Licence Fees are determined by the non-domestic rateable value of the premises.

To find out a premises non domestic rateable value go to the Valuation Office Agency site at http://www.voa.gov.uk/business_rates/index.htm

Band A - No RV to £4300 £100.00

Band B - £4301 to £33000 £190.00

Band C - £33001 to £87000 £315.00

Band D - £87001 to £12500 £450.00*

Band E - £125001 and over £635.00*

*If the premises rateable value is in Bands D or E and the premises is primarily used for the consumption of alcohol on the premises then your are required to pay a higher fee

Band D - £87001 to £12500 £900.00

Band E - £125001 and over £1,905.00

There is an exemption from the payment of fees in relation to the provision of regulated entertainment at church halls, chapel halls or premises of a similar nature, village halls, parish or community halls, or other premises of a similar nature. The costs associated with these licences will be met by central Government. If, however, the licence also authorises the use of the premises for the supply of alcohol or the provision of late night refreshment, a fee will be required.

Schools and sixth form colleges are exempt from the fees associated with the authorisation of regulated entertainment where the entertainment is provided by and at the school or college and for the purposes of the school or college.

If you operate a large event you are subject to ADDITIONAL fees based upon the number in attendance at any one time

Capacity 5000-9999 £1,000.00

Capacity 10000 -14999 £2,000.00

Capacity 15000-19999 £4,000.00

Capacity 20000-29999 £8,000.00

Capacity 30000-39000 £16,000.00

Capacity 40000-49999 £24,000.00

Capacity 50000-59999 £32,000.00

Capacity 60000-69999 £40,000.00

Capacity 70000-79999 £48,000.00

Capacity 80000-89999 £56,000.00

Capacity 90000 and over £64,000.00

* Fee amount (£)

190.00

ATTACHMENTS

AUTHORITY POSTAL ADDRESS

Continued from previous page...

Address

Building number or name	<input type="text"/>
Street	<input type="text"/>
District	<input type="text"/>
City or town	<input type="text"/>
County or administrative area	<input type="text"/>
Postcode	<input type="text"/>
Country	<input type="text" value="United Kingdom"/>

DECLARATION

* Please visit www.bury.gov.uk/privacy to read our recently updated Privacy Policy which explains how Bury Council uses and shares your personal data to give you the best possible experience across our services.

I/we understand it is an offence, liable on conviction to a fine up to level 5 on the standard scale, under section 158 of the licensing act 2003, to make a false statement in or in connection with this application. (Applicable to individual applicants only, including those in a partnership which is not a limited liability partnership) I understand I am not entitled to be issued with a licence if I do not have the entitlement to live and work in the UK (or if I am subject to a condition

* preventing me from doing work relating to the carrying on of a licensable activity) and that my licence will become invalid if I cease to be entitled to live and work in the UK (please read guidance note 15). The DPS named in this application form is entitled to work in the UK (and is not subject to conditions preventing him or her from doing work relating to a licensable activity) and I have seen a copy of his or her proof of entitlement to work, if appropriate (please see note 15)

Ticking this box indicates you have read and understood the above declaration

This section should be completed by the applicant, unless you answered "Yes" to the question "Are you an agent acting on behalf of the applicant?"

* Full name	<input type="text"/>
* Capacity	<input type="text"/>
Date (dd/mm/yyyy)	<input type="text"/>

Once you're finished you need to do the following:

1. Save this form to your computer by clicking file/save as...
2. Go back to <https://www.gov.uk/apply-for-a-licence/premises-licence/bury/apply-1> to upload this file and continue with your application.

Don't forget to make sure you have all your supporting documentation to hand.

Continued from previous page...

IT IS AN OFFENCE LIABLE TO SUMMARY CONVICTION TO A FINE OF ANY AMOUNT UNDER SECTION 158 OF THE LICENSING ACT 2003, TO MAKE A FALSE STATEMENT IN OR IN CONNECTION WITH THIS APPLICATION

IT IS AN OFFENCE UNDER SECTION 24B OF THE IMMIGRATION ACT 1971 FOR A PERSON TO WORK WHEN THEY KNOW, OR HAVE REASONABLE CAUSE TO BELIEVE, THAT THEY ARE DISQUALIFIED FROM DOING SO BY REASON OF THEIR IMMIGRATION STATUS. THOSE WHO EMPLOY AN ADULT WITHOUT LEAVE OR WHO IS SUBJECT TO CONDITIONS AS TO EMPLOYMENT WILL BE LIABLE TO A CIVIL PENALTY UNDER SECTION 15 OF THE IMMIGRATION, ASYLUM AND NATIONALITY ACT 2006 AND PURSUANT TO SECTION 21 OF THE SAME ACT, WILL BE COMMITTING AN OFFENCE WHERE THEY DO SO IN THE KNOWLEDGE, OR WITH REASONABLE CAUSE TO BELIEVE, THAT THE EMPLOYEE IS DISQUALIFIED

JUN 2020

MYLES TRADING

2. A THE PARADE

RUFFORD DRIVE

WHITEFIELD DRIVE

M45 SPL

SCALE 1-100

S - SHELVING

F - FREEZER

C - COOLER

SI - SINK

FE - FIRE EXTINGUISHER

B+W - BEERS AND WINES

● - LICENCE AREA

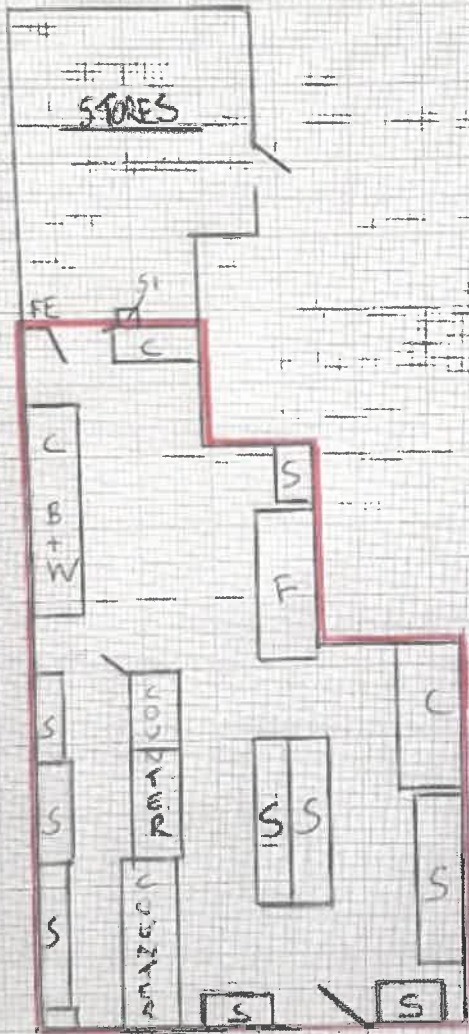

SPIRITS BEHIND COUNTER

ENTRANCE

Privacy Policy

updated by... explains... experience ac...

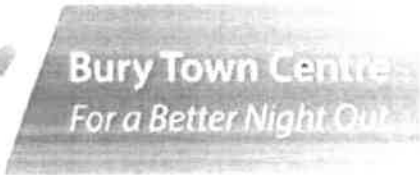

From: Diane [mailto:diburdaky@gmail.com]
Sent: 04 August 2020 19:05
To: Licensing <Licensing@bury.gov.uk>
Subject: APPLICATION 065529, 2A THE PARADE, RUFFORD DRIVE, WHITEFIELD. M45 8PL

Dear Sir or Madam,

I would like to raise a number of concerns that I have regarding the alcohol licence application for the above.

I live across the road from Rufford Drive Post Office.

It changed hands a couple of years ago, shut down for refurbishments and since it reopened the service, reliability & general operation has been very, very poor.

It (the shop) has quite frankly gone to the wall. It is no longer the essential Post Office and community hub it used to be.

It used to open at 7am. It offered a great service not only as a Post Office but as a newsagent, stationers, greeting card seller & sweet shop, whilst also selling essential groceries such as bread, milk, tea, coffee, sugar etc. This was great for the local community, especially the elderly who would pop in for their morning paper & a pint of milk before 9am.

They no longer act as a newsagent, they no longer sell greeting cards. The very things that they were known for & that local people depended on them for has disappeared. Instead they appeared to diversify by turning the shop into a mobile phone repair & accessory business.

This didn't last long.

The shop became empty again apart from the Post Office service.

As a Post Office it has been closed down at least twice whilst internal Post office investigations took place. The Police were also involved.

I believe that the owners of this shop are also the same owners of the Post Office / Bargain Booze on Manchester Road, which was also temporarily closed down pending internal & police investigations.

This may be one of the reasons that their licence as a National Lottery operator was taken away.

As a Post Office it frequently opens late & closes early. I have put in official complaints about this.

The staffing is inadequate. There is one person serving and queues are often through the door.

A few months ago a friend of mine deposited some money into his bank account via this Post Office & it didn't reach his bank account. Two weeks ago there were some complaints from local people whose debit cards had been cloned. All of them were regular users of this shop to withdraw money.

The accommodation above the shop is currently empty. Until recently it was occupied by upto eight people. It has been raided by the police (whilst under the current owners) and charges were brought for criminal activities.

The application by Mr L. Thomas / Myles Trading is suspicious as the shop is operated by Asians, none of whom have the surname of Thomas.

I would also like to point out that there is a general store / off licence / tobacconist operating two doors away, which is run by Mr & Mrs Singh, who are a much loved & integral part of our local community. Their well established family owned store has served our local community for over 16 years. I can speak from personal experience when I say that the family have been exceptional in their efforts to help the local's, especially the elderly during the ongoing Covid 19 pandemic. They have gone far beyond their roles as shopkeepers and have, at their own personal expense, supported and helped the local people with disability & health problems.

Granting an alcohol licence that is in direct competition to them could be fatal to their business, which has already suffered from the opening of local supermarkets.

Mr & Mrs Singhs shop is open from 9am until 10pm 365 days a year.

There is no need for another shop selling alcohol, especially at the proposed opening hours, 7am until 11pm. 7am is too early, 11pm is too late. These opening hours could cause disruption and anti-social behaviour from alcohol dependent people.

Whilst I feel we should support and encourage our local businesses, the granting of the above licence is not of any benefit to the residents of Rufford Drive and the surrounding community.

I am concerned by the prior criminal investigations and suspicious ongoing activities within the shop & its residential premises.

I therefore urge you in the strongest terms to deny the above licence application.

Yours faithfully,

D. Buurdaky.

----- Why not visit our website www.bury.gov.uk -----
----- Incoming and outgoing e-mail messages are routinely monitored for compliance with our information security policy. The information contained in this e-mail and any files transmitted with it is for the intended recipient(s) alone. It may contain confidential information that is exempt from the disclosure under English law and may also be covered by legal, professional or other privilege. If you are not the intended recipient, you must not copy, distribute or take any action in reliance on it. If you have received this e-mail in error, please notify us immediately by using the reply facility on your e-mail system. If this message is being transmitted over the Internet, be aware that it may be intercepted by third parties. As a public body, the Council may be required to disclose this e-mail or any response to it under the Freedom of Information Act 2000 unless the information in it is covered by one of the exemptions in the Act. Electronic or fax Service of documents is not accepted. New legislation governing the way we protect your personal data is now in force from the 25th May 2018. For information on how we protect and look after your personal data and to find out more about your

individual rights about personal data we hold on you please go to our website:
<https://www.bury.gov.uk/privacy>

Bridge, Michael

From: Jones, Laura J (Licensing)
Sent: 20 August 2020 14:16
To: Bridge, Michael
Subject: Fw: APPLICATION FOR A PREMISES LICENCE - MYLES TRADING, 2A THE PARADE, RUFFORD DRIVE

From: Ian Rushton <ijrushy@hotmail.com>
Sent: 20 August 2020 13:13:28
To: Diane
Cc: Jones, Laura J (Licensing)
Subject: RE: APPLICATION FOR A PREMISES LICENCE - MYLES TRADING, 2A THE PARADE, RUFFORD DRIVE

Dear Mrs Buurkady

Thanks for your email, all noted.

In answer to your queries;

1. Yes, Mr Thomas will be working in the shop full time as the designated premises supervisor. Of course, there will be times when he isn't there – for example going to the wholesalers, holidays, etc. He will be the responsible person in terms of alcohol sales from the shop.
2. The post office part is separate to Mr Thomas, the post office will continue to be run by the same person independent from Mr Thomas. Mr Thomas is responsible for the general convenience part of the business including the proposed alcohol sales.
3. I can reiterate that Mr Thomas has only taken on the lease for the shop part of the business. He has absolutely no involvement with the flat above.
4. The shop will continue to be a general convenience store selling a range of goods – alcohol sales would just be a part of the overall business.
5. People who have confirmed that they support the shop/licence application are from a number of streets in the area including Rufford Drive. The Council have advised that the only objection that they have received from a local resident is your letter. I am not aware of any petition.
6. Mr Thomas is a genuine and responsible person and will make sure that the shop – with alcohol sales – would run well. The licence conditions we have proposed are comprehensive and would promote the licensing objectives. These include CCTV, a refusals register and a strict alcohol refusals policy, etc. The Police are satisfied that a licence can be issued, as are all of the other responsible authorities including the Licensing Authority, Trading Standards, etc.

Hope this helps.

Regards, Ian

Ian Rushton
JL Licence and Retail
07909 511953

Sent from Mail for Windows 10

From: Diane
Sent: 20 August 2020 06:24
To: Ian Rushton
Cc: Jones, Laura J (Licensing)
Subject: Re: APPLICATIN FOR A PREMSIES LICENCE - MYLES TRADING, 2A THE PARADE, RUFFORD DRIVE

39 Rufford Drive
Whitefield
Manchester
M45 8PN
20th August 2020

Dear Mr Rushton,

RE: APPLICATION FOR NEW PREMISES LICENCE
2A THE PARADE, RUFFORD DRIVE, WHITEFIELD.

Thank you for your letter of 19th August 2020 regarding the above.

I would like to address some of your points as follows:

The applicant, Mr Lijo Thomas is the personal licence holder and the designated premises supervisor. Please can you clarify the extent of Mr Thomas's involvement in the shop. Will he be there every day to fulfil his role as licence holder / premises supervisor?

The Post Office is still being operated by the same person that has been there for the last couple of years. Is this person independent & not employed by Mr Thomas as the proprietor of the shop?

The landlord of the building leases it as a whole, including the flat above. I have personally witnessed anti-social activities from the flat, which have involved the police. Can you categorically confirm that Mr Thomas and / or his business partners do not have any responsibility or business interests for the flat?

The feedback you mention from the local community consists of 77 signatures, all of whom I suspect are Post Office customers and not local residents from The Elms Estate. I would be interested to see the postal addresses of these people.

I believe that there are over 200 signatures from LOCAL people objecting to the proposed licence.

I am well aware of the regulations and conditions attached to granting an alcohol licence, however there are other factors that must be considered.

Within our local community there are a number of one-bedroom flats, many of which are occupied by alcohol / drug dependent / mentally ill people. Some of these residents are known by the police for their anti-social behaviour.

The off licence two doors from the Post Office have a zero-tolerance policy. They have been very successful in ridding the community of some of these awful people by their vigilance, refusals to sell & banning troublesome people from their shop.

I am greatly concerned that the introduction of a new off licence will be frequented by some of these anti-social people and cause distress to myself and my neighbour's.

I live directly opposite the shop and have been a customer for many years. It will be nice to finally see it back as the thriving business it once was, as a Post Office & Newsagent.

But it will not be a newsagent.

Instead, if the licence application is granted it will become an off licence, which is of no benefit to the local community & is potentially a troublesome tinder box for myself and my neighbours.

Document Pack Page 33

Yours sincerely
D Burdaky

On Wed, 19 Aug 2020 at 12:17, Ian Rushton <ijrushy@hotmail.com> wrote:

Dear Mrs Buurdaky

Hope you are well.

I'm contacting you on behalf of Mr Lijo Thomas, the new owner of the above shop

Please see attached letter and operating schedule for your consideration.

I'd be grateful to hear from you asap and if you have any queries please let me know.

Thanks, Ian

Ian Rushton

JL Licence and Retail

07909 511953

Sent from Mail for Windows 10



Dear Sir/Madam

**APPLICATION FOR A PREMISES LICENCE
SHOP AT 2A THE PARADE, RUFFORD DRIVE, WHITEFIELD M45 8PL**

As you may be aware, I have recently taken over the shop and have applied to the Council for a premises licence to sell some alcohol 7am to 11pm daily.

The shop will continue to be a general convenience store/post office selling a wide range of goods including newspapers, magazines, bread, milk, sweets, dairy, soft drinks, cigarettes, etc. The alcohol sales would just be a part of the overall buisness.

The law requires licensed premises to promote the 4 licensing objectives which are; the prevention of crime and disorder, public safety, prevention of public nuisance and the protection of children from harm.

My application shows all the steps that I would take to promote these objectives including CCTV, regular staff training, Challenge 25 underage sales policy, etc. I attach a copy of my proposed licence conditions for your information. I will do everything I can to make sure that local residents are not in any way disturbed by my shop.

I would be grateful if you would complete the brief form below please. If you have any queries or concerns please don't hesitate to let me know, or contact the Council direct.

Thanks

Lijo Thomas (owner)

To: Bury Council Licensing, 3 Knowsley Place, Duke St, Bury BL9 0EJ

Application for a premises licence – 2a The Parade, Rufford Drive, M45 8PL

I support this application for a premises licence

I wish to object to this application

Comments/reasons (please continue on a separate sheet if necessary)

.....
.....
.....
.....

NAME Braelley Jones SIGNED [Signature]
ADDRESS 19 rufford drive



Dear Sir/Madam

**APPLICATION FOR A PREMISES LICENCE
SHOP AT 2A THE PARADE, RUFFORD DRIVE, WHITEFIELD M45 8PL**

As you may be aware, I have recently taken over the shop and have applied to the Council for a premises licence to sell some alcohol 7am to 11pm daily.

The shop will continue to be a general convenience store/post office selling a wide range of goods including newspapers, magazines, bread, milk, sweets, dairy, soft drinks, cigarettes, etc. The alcohol sales would just be a part of the overall buisness.

The law requires licensed premises to promote the 4 licensing objectives which are; the prevention of crime and disorder, public safety, prevention of public nuisance and the protection of children from harm.

My application shows all the steps that I would take to promote these objectives including CCTV, regular staff training, Challenge 25 underage sales policy, etc. I attach a copy of my proposed licence conditions for your information. I will do everything I can to make sure that local residents are not in any way disturbed by my shop.

I would be grateful if you would complete the brief form below please. If you have any queries or concerns please don't hesitate to let me know, or contact the Council direct.

Thanks

Lijo Thomas (owner)

To; Bury Council Licensing, 3 Knowsley Place, Duke St, Bury BL9 0EJ

Application for a premises licence – 2a The Parade, Rufford Drive, M45 8PL

I support this application for a premises licence

I wish to object to this application

Comments/reasons (please continue on a separate sheet if necessary)
.....
.....
.....
.....

NAME Lijo Thomas SIGNED [Signature]

ADDRESS 23 Rufford Drive



Dear Sir/Madam

**APPLICATION FOR A PREMISES LICENCE
SHOP AT 2A THE PARADE, RUFFORD DRIVE, WHITEFIELD M45 8PL**

As you may be aware, I have recently taken over the shop and have applied to the Council for a premises licence to sell some alcohol 7am to 11pm daily.

The shop will continue to be a general convenience store/post office selling a wide range of goods including newspapers, magazines, bread, milk, sweets, dairy, soft drinks, cigarettes, etc. The alcohol sales would just be a part of the overall business.

The law requires licensed premises to promote the 4 licensing objectives which are; the prevention of crime and disorder, public safety, prevention of public nuisance and the protection of children from harm.

My application shows all the steps that I would take to promote these objectives including CCTV, regular staff training, Challenge 25 underage sales policy, etc. I attach a copy of my proposed licence conditions for your information. I will do everything I can to make sure that local residents are not in any way disturbed by my shop.

I would be grateful if you would complete the brief form below please. If you have any queries or concerns please don't hesitate to let me know, or contact the Council direct.

Thanks

Lijo Thomas (owner)

To; Bury Council Licensing, 3 Knowsley Place, Duke St, Bury BL9 0EJ

Application for a premises licence – 2a The Parade, Rufford Drive, M45 8PL

I support this application for a premises licence

I wish to object to this application

Comments/reasons (please continue on a separate sheet if necessary)

.....
.....
.....
.....

NAME Andrew SIGNED [Signature]

ADDRESS 12 Thurston Close

Dear Sir/Madam

**APPLICATION FOR A PREMISES LICENCE
SHOP AT 2A THE PARADE, RUFFORD DRIVE, WHITEFIELD M45 8PL**

As you may be aware, I have recently taken over the shop and have applied to the Council for a premises licence to sell some alcohol 7am to 11pm daily.

The shop will continue to be a general convenience store/post office selling a wide range of goods including newspapers, magazines, bread, milk, sweets, dairy, soft drinks, cigarettes, etc. The alcohol sales would just be a part of the overall buisness.

The law requires licensed premises to promote the 4 licensing objectives which are; the prevention of crime and disorder, public safety, prevention of public nuisance and the protection of children from harm.

My application shows all the steps that I would take to promote these objectives including CCTV, regular staff training, Challenge 25 underage sales policy, etc. I attach a copy of my proposed licence conditions for your information. I will do everything I can to make sure that local residents are not in any way disturbed by my shop.

I would be grateful if you would complete the brief form below please. If you have any queries or concerns please don't hesitate to let me know, or contact the Council direct.

Thanks

Lijo Thomas (owner)

To; Bury Council Licensing, 3 Knowsley Place, Duke St, Bury BL9 0EJ

Application for a premises licence – 2a The Parade, Rufford Drive, M45 8PL

I support this application for a premises licence

I wish to object to this application

Comments/reasons (please continue on a separate sheet if necessary)

.....
.....
.....
.....

NAME *Alexandra Hornos* SIGNED..... 
ADDRESS..... *M45 8PL 105 Malton Avenue*.....

Dear Sir/Madam

**APPLICATION FOR A PREMISES LICENCE
SHOP AT 2A THE PARADE, RUFFORD DRIVE, WHITEFIELD M45 8PL**

As you may be aware, I have recently taken over the shop and have applied to the Council for a premises licence to sell some alcohol 7am to 11pm daily.

The shop will continue to be a general convenience store/post office selling a wide range of goods including newspapers, magazines, bread, milk, sweets, dairy, soft drinks, cigarettes, etc. The alcohol sales would just be a part of the overall business.

The law requires licensed premises to promote the 4 licensing objectives which are; the prevention of crime and disorder, public safety, prevention of public nuisance and the protection of children from harm.

My application shows all the steps that I would take to promote these objectives including CCTV, regular staff training, Challenge 25 underage sales policy, etc. I attach a copy of my proposed licence conditions for your information. I will do everything I can to make sure that local residents are not in any way disturbed by my shop.

I would be grateful if you would complete the brief form below please. If you have any queries or concerns please don't hesitate to let me know, or contact the Council direct.

Thanks

Lijo Thomas (owner)

To; Bury Council Licensing, 3 Knowsley Place, Duke St, Bury BL9 0EJ

Application for a premises licence – 2a The Parade, Rufford Drive, M45 8PL

I support this application for a premises licence

I wish to object to this application

Comments/reasons (please continue on a separate sheet if necessary)

.....

.....

.....

.....

NAME 72 Mather Ave SIGNED J. Thomas

ADDRESS J. Thomas

Dear Sir/Madam

**APPLICATION FOR A PREMISES LICENCE
SHOP AT 2A THE PARADE, RUFFORD DRIVE, WHITEFIELD M45 8PL**

As you may be aware, I have recently taken over the shop and have applied to the Council for a premises licence to sell some alcohol 7am to 11pm daily.

The shop will continue to be a general convenience store/post office selling a wide range of goods including newspapers, magazines, bread, milk, sweets, dairy, soft drinks, cigarettes, etc. The alcohol sales would just be a part of the overall business.

The law requires licensed premises to promote the 4 licensing objectives which are; the prevention of crime and disorder, public safety, prevention of public nuisance and the protection of children from harm.

My application shows all the steps that I would take to promote these objectives including CCTV, regular staff training, Challenge 25 underage sales policy, etc. I attach a copy of my proposed licence conditions for your information. I will do everything I can to make sure that local residents are not in any way disturbed by my shop.

I would be grateful if you would complete the brief form below please. If you have any queries or concerns please don't hesitate to let me know, or contact the Council direct.

Thanks

Lijo Thomas (owner)

To; Bury Council Licensing, 3 Knowsley Place, Duke St, Bury BL9 0EJ

Application for a premises licence – 2a The Parade, Rufford Drive, M45 8PL

I support this application for a premises licence

I wish to object to this application

Comments/reasons (please continue on a separate sheet if necessary)

.....
.....
.....
.....

NAME ABBAYSON SIGNED..... [Signature].....

ADDRESS..... 24 MATHER AVE..... WHITEFIELD.....

Dear Sir/Madam

**APPLICATION FOR A PREMISES LICENCE
SHOP AT 2A THE PARADE, RUFFORD DRIVE, WHITEFIELD M45 8PL**

As you may be aware, I have recently taken over the shop and have applied to the Council for a premises licence to sell some alcohol 7am to 11pm daily.

The shop will continue to be a general convenience store/post office selling a wide range of goods including newspapers, magazines, bread, milk, sweets, dairy, soft drinks, cigarettes, etc. The alcohol sales would just be a part of the overall buisness.

The law requires licensed premises to promote the 4 licensing objectives which are; the prevention of crime and disorder, public safety, prevention of public nuisance and the protection of children from harm.

My application shows all the steps that I would take to promote these objectives including CCTV, regular staff training, Challenge 25 underage sales policy, etc. I attach a copy of my proposed licence conditions for your information. I will do everything I can to make sure that local residents are not in any way disturbed by my shop.

I would be grateful if you would complete the brief form below please. If you have any queries or concerns please don't hesitate to let me know, or contact the Council direct.

Thanks

Lijo Thomas (owner)

To; Bury Council Licensing, 3 Knowsley Place, Duke St, Bury BL9 0EJ

Application for a premises licence – 2a The Parade, Rufford Drive, M45 8PL

I support this application for a premises licence

I wish to object to this application

Comments/reasons (please continue on a separate sheet if necessary)

.....
.....
.....
.....

NAME *Sam* SIGNED *[Signature]*

ADDRESS *2a Rufford Drive* *Whitefield* *M45 8PL*

Dear Sir/Madam

**APPLICATION FOR A PREMISES LICENCE
SHOP AT 2A THE PARADE, RUFFORD DRIVE, WHITEFIELD M45 8PL**

As you may be aware, I have recently taken over the shop and have applied to the Council for a premises licence to sell some alcohol 7am to 11pm daily.

The shop will continue to be a general convenience store/post office selling a wide range of goods including newspapers, magazines, bread, milk, sweets, dairy, soft drinks, cigarettes, etc. The alcohol sales would just be a part of the overall buisness.

The law requires licensed premises to promote the 4 licensing objectives which are; the prevention of crime and disorder, public safety, prevention of public nuisance and the protection of children from harm.

My application shows all the steps that I would take to promote these objectives including CCTV, regular staff training, Challenge 25 underage sales policy, etc. I attach a copy of my proposed licence conditions for your information. I will do everything I can to make sure that local residents are not in any way disturbed by my shop.

I would be grateful if you would complete the brief form below please. If you have any queries or concerns please don't hesitate to let me know, or contact the Council direct.

Thanks

Lijo Thomas (owner)

To; Bury Council Licensing, 3 Knowsley Place, Duke St, Bury BL9 0EJ

Application for a premises licence – 2a The Parade, Rufford Drive, M45 8PL

I support this application for a premises licence

I wish to object to this application

Comments/reasons (please continue on a separate sheet if necessary)

.....
.....
.....
.....

NAME Vincent Owens SIGNED [Signature]

ADDRESS 35 Ripon Close

Dear Sir/Madam

**APPLICATION FOR A PREMISES LICENCE
SHOP AT 2A THE PARADE, RUFFORD DRIVE, WHITEFIELD M45 8PL**

As you may be aware, I have recently taken over the shop and have applied to the Council for a premises licence to sell some alcohol 7am to 11pm daily.

The shop will continue to be a general convenience store/post office selling a wide range of goods including newspapers, magazines, bread, milk, sweets, dairy, soft drinks, cigarettes, etc. The alcohol sales would just be a part of the overall business.

The law requires licensed premises to promote the 4 licensing objectives which are; the prevention of crime and disorder, public safety, prevention of public nuisance and the protection of children from harm.

My application shows all the steps that I would take to promote these objectives including CCTV, regular staff training, Challenge 25 underage sales policy, etc. I attach a copy of my proposed licence conditions for your information. I will do everything I can to make sure that local residents are not in any way disturbed by my shop.

I would be grateful if you would complete the brief form below please. If you have any queries or concerns please don't hesitate to let me know, or contact the Council direct.

Thanks

Lijo Thomas (owner)

To; Bury Council Licensing, 3 Knowsley Place, Duke St, Bury BL9 0EJ

Application for a premises licence – 2a The Parade, Rufford Drive, M45 8PL

I support this application for a premises licence

I wish to object to this application

Comments/reasons (please continue on a separate sheet if necessary)

.....
.....
.....
.....

NAME Stephen MAHON SIGNED S.Mahon

ADDRESS 31 Ripon close Whitefield M45 8PL

Dear Sir/Madam

**APPLICATION FOR A PREMISES LICENCE
SHOP AT 2A THE PARADE, RUFFORD DRIVE, WHITEFIELD M45 8PL**

As you may be aware, I have recently taken over the shop and have applied to the Council for a premises licence to sell some alcohol 7am to 11pm daily.

The shop will continue to be a general convenience store/post office selling a wide range of goods including newspapers, magazines, bread, milk, sweets, dairy, soft drinks, cigarettes, etc. The alcohol sales would just be a part of the overall business.

The law requires licensed premises to promote the 4 licensing objectives which are; the prevention of crime and disorder, public safety, prevention of public nuisance and the protection of children from harm.

My application shows all the steps that I would take to promote these objectives including CCTV, regular staff training, Challenge 25 underage sales policy, etc. I attach a copy of my proposed licence conditions for your information. I will do everything I can to make sure that local residents are not in any way disturbed by my shop.

I would be grateful if you would complete the brief form below please. If you have any queries or concerns please don't hesitate to let me know, or contact the Council direct.

Thanks

Lijo Thomas (owner)

To; Bury Council Licensing, 3 Knowsley Place, Duke St, Bury BL9 0EJ

Application for a premises licence – 2a The Parade, Rufford Drive, M45 8PL

I support this application for a premises licence

I wish to object to this application

Comments/reasons (please continue on a separate sheet if necessary)

NAME *Sunder Singh Kalra* SIGNED *[Signature]*
ADDRESS *11 PIPON Avenue Whitefield M45 8PL*

Dear Sir/Madam

**APPLICATION FOR A PREMISES LICENCE
SHOP AT 2A THE PARADE, RUFFORD DRIVE, WHITEFIELD M45 8PL**

As you may be aware, I have recently taken over the shop and have applied to the Council for a premises licence to sell some alcohol 7am to 11pm daily.

The shop will continue to be a general convenience store/post office selling a wide range of goods including newspapers, magazines, bread, milk, sweets, dairy, soft drinks, cigarettes, etc. The alcohol sales would just be a part of the overall business.

The law requires licensed premises to promote the 4 licensing objectives which are; the prevention of crime and disorder, public safety, prevention of public nuisance and the protection of children from harm.

My application shows all the steps that I would take to promote these objectives including CCTV, regular staff training, Challenge 25 underage sales policy, etc. I attach a copy of my proposed licence conditions for your information. I will do everything I can to make sure that local residents are not in any way disturbed by my shop.

I would be grateful if you would complete the brief form below please. If you have any queries or concerns please don't hesitate to let me know, or contact the Council direct.

Thanks

Lijo Thomas (owner)

To; Bury Council Licensing, 3 Knowsley Place, Duke St, Bury BL9 0EJ

Application for a premises licence – 2a The Parade, Rufford Drive, M45 8PL

I support this application for a premises licence

I wish to object to this application

Comments/reasons (please continue on a separate sheet if necessary)

.....

.....

.....

.....

NAME D. Henderson SIGNED [Signature]

ADDRESS 2 Ripon Close Whitefield

Dear Sir/Madam

**APPLICATION FOR A PREMISES LICENCE
SHOP AT 2A THE PARADE, RUFFORD DRIVE, WHITEFIELD M45 8PL**

As you may be aware, I have recently taken over the shop and have applied to the Council for a premises licence to sell some alcohol 7am to 11pm daily.

The shop will continue to be a general convenience store/post office selling a wide range of goods including newspapers, magazines, bread, milk, sweets, dairy, soft drinks, cigarettes, etc. The alcohol sales would just be a part of the overall buisness.

The law requires licensed premises to promote the 4 licensing objectives which are; the prevention of crime and disorder, public safety, prevention of public nuisance and the protection of children from harm.

My application shows all the steps that I would take to promote these objectives including CCTV, regular staff training, Challenge 25 underage sales policy, etc. I attach a copy of my proposed licence conditions for your information. I will do everything I can to make sure that local residents are not in any way disturbed by my shop.

I would be grateful if you would complete the brief form below please. If you have any queries or concerns please don't hesitate to let me know, or contact the Council direct.

Thanks

Lijo Thomas (owner)

To; Bury Council Licensing, 3 Knowsley Place, Duke St, Bury BL9 0EJ

Application for a premises licence – 2a The Parade, Rufford Drive, M45 8PL

I support this application for a premises licence

I wish to object to this application

Comments/reasons (please continue on a separate sheet if necessary)

.....
.....
.....
.....

NAME **DAVID HUGHES** SIGNED *[Signature]*

ADDRESS **2 BIRKTON AVENUE WHITEFIELD**

Dear Sir/Madam

**APPLICATION FOR A PREMISES LICENCE
SHOP AT 2A THE PARADE, RUFFORD DRIVE, WHITEFIELD M45 8PL**

As you may be aware, I have recently taken over the shop and have applied to the Council for a premises licence to sell some alcohol 7am to 11pm daily.

The shop will continue to be a general convenience store/post office selling a wide range of goods including newspapers, magazines, bread, milk, sweets, dairy, soft drinks, cigarettes, etc. The alcohol sales would just be a part of the overall business.

The law requires licensed premises to promote the 4 licensing objectives which are; the prevention of crime and disorder, public safety, prevention of public nuisance and the protection of children from harm.

My application shows all the steps that I would take to promote these objectives including CCTV, regular staff training, Challenge 25 underage sales policy, etc. I attach a copy of my proposed licence conditions for your information. I will do everything I can to make sure that local residents are not in any way disturbed by my shop.

I would be grateful if you would complete the brief form below please. If you have any queries or concerns please don't hesitate to let me know, or contact the Council direct.

Thanks

Lijo Thomas (owner)

To; Bury Council Licensing, 3 Knowsley Place, Duke St, Bury BL9 0EJ

Application for a premises licence – 2a The Parade, Rufford Drive, M45 8PL

I support this application for a premises licence

I wish to object to this application

Comments/reasons (please continue on a separate sheet if necessary)

.....
.....
.....

.....
.....
.....
NAME *Robert Soowin* SIGNED *[Signature]*
ADDRESS *3 ABINGDON AVE, WHITEFIELD*

Dear Sir/Madam

**APPLICATION FOR A PREMISES LICENCE
SHOP AT 2A THE PARADE, RUFFORD DRIVE, WHITEFIELD M45 8PL**

As you may be aware, I have recently taken over the shop and have applied to the Council for a premises licence to sell some alcohol 7am to 11pm daily.

The shop will continue to be a general convenience store/post office selling a wide range of goods including newspapers, magazines, bread, milk, sweets, dairy, soft drinks, cigarettes, etc. The alcohol sales would just be a part of the overall business.

The law requires licensed premises to promote the 4 licensing objectives which are; the prevention of crime and disorder, public safety, prevention of public nuisance and the protection of children from harm.

My application shows all the steps that I would take to promote these objectives including CCTV, regular staff training, Challenge 25 underage sales policy, etc. I attach a copy of my proposed licence conditions for your information. I will do everything I can to make sure that local residents are not in any way disturbed by my shop.

I would be grateful if you would complete the brief form below please. If you have any queries or concerns please don't hesitate to let me know, or contact the Council direct.

Thanks

Lijo Thomas (owner)

To; Bury Council Licensing, 3 Knowsley Place, Duke St, Bury BL9 0EJ

Application for a premises licence – 2a The Parade, Rufford Drive, M45 8PL

I support this application for a premises licence

I wish to object to this application

Comments/reasons (please continue on a separate sheet if necessary)

.....
.....
.....

NAME KEVIN GRINDROD SIGNED 

ADDRESS 4 Blackley close BL9 8LV

Dear Sir/Madam

**APPLICATION FOR A PREMISES LICENCE
SHOP AT 2A THE PARADE, RUFFORD DRIVE, WHITEFIELD M45 8PL**

As you may be aware, I have recently taken over the shop and have applied to the Council for a premises licence to sell some alcohol 7am to 11pm daily.

The shop will continue to be a general convenience store/post office selling a wide range of goods including newspapers, magazines, bread, milk, sweets, dairy, soft drinks, cigarettes, etc. The alcohol sales would just be a part of the overall buisness.

The law requires licensed premises to promote the 4 licensing objectives which are; the prevention of crime and disorder, public safety, prevention of public nuisance and the protection of children from harm.

My application shows all the steps that I would take to promote these objectives including CCTV, regular staff training, Challenge 25 underage sales policy, etc. I attach a copy of my proposed licence conditions for your information. I will do everything I can to make sure that local residents are not in any way disturbed by my shop.

I would be grateful if you would complete the brief form below please. If you have any queries or concerns please don't hesitate to let me know, or contact the Council direct.

Thanks

Lijo Thomas (owner)

To; Bury Council Licensing, 3 Knowsley Place, Duke St, Bury BL9 0EJ

Application for a premises licence – 2a The Parade, Rufford Drive, M45 8PL

I support this application for a premises licence

I wish to object to this application

Comments/reasons (please continue on a separate sheet if necessary)

.....
.....
.....

NAME Maura Davenport SIGNED: [Signature]
ADDRESS 33 Brookdene Road
BL9 8ND.

Dear Sir/Madam

**APPLICATION FOR A PREMISES LICENCE
SHOP AT 2A THE PARADE, RUFFORD DRIVE, WHITEFIELD M45 8PL**

As you may be aware, I have recently taken over the shop and have applied to the Council for a premises licence to sell some alcohol 7am to 11pm daily.

The shop will continue to be a general convenience store/post office selling a wide range of goods including newspapers, magazines, bread, milk, sweets, dairy, soft drinks, cigarettes, etc. The alcohol sales would just be a part of the overall business.

The law requires licensed premises to promote the 4 licensing objectives which are; the prevention of crime and disorder, public safety, prevention of public nuisance and the protection of children from harm.

My application shows all the steps that I would take to promote these objectives including CCTV, regular staff training, Challenge 25 underage sales policy, etc. I attach a copy of my proposed licence conditions for your information. I will do everything I can to make sure that local residents are not in any way disturbed by my shop.

I would be grateful if you would complete the brief form below please. If you have any queries or concerns please don't hesitate to let me know, or contact the Council direct.

Thanks

Lijo Thomas (owner)

To; Bury Council Licensing, 3 Knowsley Place, Duke St, Bury BL9 0EJ

Application for a premises licence – 2a The Parade, Rufford Drive, M45 8PL

I support this application for a premises licence

I wish to object to this application

Comments/reasons (please continue on a separate sheet if necessary)

friendly, affordable, helpful

NAME JANUA BEARDWOOD SIGNED JL

ADDRESS 26 RUFFORD BOLTON ROAD M25 4LD

Dear Sir/Madam

**APPLICATION FOR A PREMISES LICENCE
SHOP AT 2A THE PARADE, RUFFORD DRIVE, WHITEFIELD M45 8PL**

As you may be aware, I have recently taken over the shop and have applied to the Council for a premises licence to sell some alcohol 7am to 11pm daily.

The shop will continue to be a general convenience store/post office selling a wide range of goods including newspapers, magazines, bread, milk, sweets, dairy, soft drinks, cigarettes, etc. The alcohol sales would just be a part of the overall buisness.

The law requires licensed premises to promote the 4 licensing objectives which are; the prevention of crime and disorder, public safety, prevention of public nuisance and the protection of children from harm.

My application shows all the steps that I would take to promote these objectives including CCTV, regular staff training, Challenge 25 underage sales policy, etc. I attach a copy of my proposed licence conditions for your information. I will do everything I can to make sure that local residents are not in any way disturbed by my shop.

I would be grateful if you would complete the brief form below please. If you have any queries or concerns please don't hesitate to let me know, or contact the Council direct.

Thanks

Lijo Thomas (owner)

To; Bury Council Licensing, 3 Knowsley Place, Duke St, Bury BL9 0EJ

Application for a premises licence – 2a The Parade, Rufford Drive, M45 8PL

I support this application for a premises licence

I wish to object to this application

Comments/reasons (please continue on a separate sheet if necessary)

.....
great staff
.....

NAME Terri-mae Lunt..... SIGNED Terri-lunt.....

ADDRESS 121a bury old road.....

Dear Sir/Madam

**APPLICATION FOR A PREMISES LICENCE
SHOP AT 2A THE PARADE, RUFFORD DRIVE, WHITEFIELD M45 8PL**

As you may be aware, I have recently taken over the shop and have applied to the Council for a premises licence to sell some alcohol 7am to 11pm daily.

The shop will continue to be a general convenience store/post office selling a wide range of goods including newspapers, magazines, bread, milk, sweets, dairy, soft drinks, cigarettes, etc. The alcohol sales would just be a part of the overall buisness.

The law requires licensed premises to promote the 4 licensing objectives which are; the prevention of crime and disorder, public safety, prevention of public nuisance and the protection of children from harm.

My application shows all the steps that I would take to promote these objectives including CCTV, regular staff training, Challenge 25 underage sales policy, etc. I attach a copy of my proposed licence conditions for your information. I will do everything I can to make sure that local residents are not in any way disturbed by my shop.

I would be grateful if you would complete the brief form below please. If you have any queries or concerns please don't hesitate to let me know, or contact the Council direct.

Thanks

Lijo Thomas (owner)

To; Bury Council Licensing, 3 Knowsley Place, Duke St, Bury BL9 0EJ

Application for a premises licence – 2a The Parade, Rufford Drive, M45 8PL

I support this application for a premises licence

I wish to object to this application

Comments/reasons (please continue on a separate sheet if necessary)

NAME L. Parkin SIGNED [Signature]
ADDRESS 337 B. New Rd M45 7SE

Dear Sir/Madam

**APPLICATION FOR A PREMISES LICENCE
SHOP AT 2A THE PARADE, RUFFORD DRIVE, WHITEFIELD M45 8PL**

As you may be aware, I have recently taken over the shop and have applied to the Council for a premises licence to sell some alcohol 7am to 11pm daily.

The shop will continue to be a general convenience store/post office selling a wide range of goods including newspapers, magazines, bread, milk, sweets, dairy, soft drinks, cigarettes, etc. The alcohol sales would just be a part of the overall buisness.

The law requires licensed premises to promote the 4 licensing objectives which are; the prevention of crime and disorder, public safety, prevention of public nuisance and the protection of children from harm.

My application shows all the steps that I would take to promote these objectives including CCTV, regular staff training, Challenge 25 underage sales policy, etc. I attach a copy of my proposed licence conditions for your information. I will do everything I can to make sure that local residents are not in any way disturbed by my shop.

I would be grateful if you would complete the brief form below please. If you have any queries or concerns please don't hesitate to let me know, or contact the Council direct.

Thanks

Lijo Thomas (owner)

To; Bury Council Licensing, 3 Knowsley Place, Duke St, Bury BL9 0EJ

Application for a premises licence – 2a The Parade, Rufford Drive, M45 8PL

I support this application for a premises licence!

I wish to object to this application

Comments/reasons (please continue on a separate sheet if necessary)

.....
.....
.....

.....
NAME AWHINSON SIGNED [Signature]
ADDRESS 369 bury new rd WHITEFIELD

Dear Sir/Madam

**APPLICATION FOR A PREMISES LICENCE
SHOP AT 2A THE PARADE, RUFFORD DRIVE, WHITEFIELD M45 8PL**

As you may be aware, I have recently taken over the shop and have applied to the Council for a premises licence to sell some alcohol 7am to 11pm daily.

The shop will continue to be a general convenience store/post office selling a wide range of goods including newspapers, magazines, bread, milk, sweets, dairy, soft drinks, cigarettes, etc. The alcohol sales would just be a part of the overall buisness.

The law requires licensed premises to promote the 4 licensing objectives which are; the prevention of crime and disorder, public safety, prevention of public nuisance and the protection of children from harm.

My application shows all the steps that I would take to promote these objectives including CCTV, regular staff training, Challenge 25 underage sales policy, etc. I attach a copy of my proposed licence conditions for your information. I will do everything I can to make sure that local residents are not in any way disturbed by my shop.

I would be grateful if you would complete the brief form below please. If you have any queries or concerns please don't hesitate to let me know, or contact the Council direct.

Thanks

Lijo Thomas (owner)

To; Bury Council Licensing, 3 Knowsley Place, Duke St, Bury BL9 0EJ

Application for a premises licence – 2a The Parade, Rufford Drive, M45 8PL

I support this application for a premises licence

I wish to object to this application

Comments/reasons (please continue on a separate sheet if necessary)

.....
.....
.....

NAME Sophie Niven SIGNED 

ADDRESS 406 Bury new rd, Whitefield, Manchester, M45 7SX

Dear Sir/Madam

**APPLICATION FOR A PREMISES LICENCE
SHOP AT 2A THE PARADE, RUFFORD DRIVE, WHITEFIELD M45 8PL**

As you may be aware, I have recently taken over the shop and have applied to the Council for a premises licence to sell some alcohol 7am to 11pm daily.

The shop will continue to be a general convenience store/post office selling a wide range of goods including newspapers, magazines, bread, milk, sweets, dairy, soft drinks, cigarettes, etc. The alcohol sales would just be a part of the overall buisness.

The law requires licensed premises to promote the 4 licensing objectives which are; the prevention of crime and disorder, public safety, prevention of public nuisance and the protection of children from harm.

My application shows all the steps that I would take to promote these objectives including CCTV, regular staff training, Challenge 25 underage sales policy, etc. I attach a copy of my proposed licence conditions for your information. I will do everything I can to make sure that local residents are not in any way disturbed by my shop.

I would be grateful if you would complete the brief form below please. If you have any queries or concerns please don't hesitate to let me know, or contact the Council direct.

Thanks

Lijo Thomas (owner)

To; Bury Council Licensing, 3 Knowsley Place, Duke St, Bury BL9 0EJ

Application for a premises licence – 2a The Parade, Rufford Drive, M45 8PL

I support this application for a premises licence

I wish to object to this application

Comments/reasons (please continue on a separate sheet if necessary)

..... affordable

.....

.....

.....

NAME Holly Hughes SIGNED Holly

ADDRESS 3 Dalebeck Close

Dear Sir/Madam

**APPLICATION FOR A PREMISES LICENCE
SHOP AT 2A THE PARADE, RUFFORD DRIVE, WHITEFIELD M45 8PL**

As you may be aware, I have recently taken over the shop and have applied to the Council for a premises licence to sell some alcohol 7am to 11pm daily.

The shop will continue to be a general convenience store/post office selling a wide range of goods including newspapers, magazines, bread, milk, sweets, dairy, soft drinks, cigarettes, etc. The alcohol sales would just be a part of the overall business.

The law requires licensed premises to promote the 4 licensing objectives which are; the prevention of crime and disorder, public safety, prevention of public nuisance and the protection of children from harm.

My application shows all the steps that I would take to promote these objectives including CCTV, regular staff training, Challenge 25 underage sales policy, etc. I attach a copy of my proposed licence conditions for your information. I will do everything I can to make sure that local residents are not in any way disturbed by my shop.

I would be grateful if you would complete the brief form below please. If you have any queries or concerns please don't hesitate to let me know, or contact the Council direct.

Thanks

Lijo Thomas (owner)

To; Bury Council Licensing, 3 Knowsley Place, Duke St, Bury BL9 0EJ

Application for a premises licence – 2a The Parade, Rufford Drive, M45 8PL

I support this application for a premises licence

I wish to object to this application

Comments/reasons (please continue on a separate sheet if necessary)

.....
.....
.....
.....

NAME *J Conway* SIGNED *J Conway*

ADDRESS *37 Dudley Ave. M45 8BS.*

Dear Sir/Madam

**APPLICATION FOR A PREMISES LICENCE
SHOP AT 2A THE PARADE, RUFFORD DRIVE, WHITEFIELD M45 8PL**

As you may be aware, I have recently taken over the shop and have applied to the Council for a premises licence to sell some alcohol 7am to 11pm daily.

The shop will continue to be a general convenience store/post office selling a wide range of goods including newspapers, magazines, bread, milk, sweets, dairy, soft drinks, cigarettes, etc. The alcohol sales would just be a part of the overall buisness.

The law requires licensed premises to promote the 4 licensing objectives which are; the prevention of crime and disorder, public safety, prevention of public nuisance and the protection of children from harm.

My application shows all the steps that I would take to promote these objectives including CCTV, regular staff training, Challenge 25 underage sales policy, etc. I attach a copy of my proposed licence conditions for your information. I will do everything I can to make sure that local residents are not in any way disturbed by my shop.

I would be grateful if you would complete the brief form below please. If you have any queries or concerns please don't hesitate to let me know, or contact the Council direct.

Thanks

Lijo Thomas (owner)

To; Bury Council Licensing, 3 Knowsley Place, Duke St, Bury BL9 0EJ

Application for a premises licence – 2a The Parade, Rufford Drive, M45 8PL

I support this application for a premises licence

I wish to object to this application

Comments/reasons (please continue on a separate sheet if necessary)

.....
.....
.....

NAME Jessica carolan SIGNED JCO

ADDRESS 12 fairway road

Dear Sir/Madam

**APPLICATION FOR A PREMISES LICENCE
SHOP AT 2A THE PARADE, RUFFORD DRIVE, WHITEFIELD M45 8PL**

As you may be aware, I have recently taken over the shop and have applied to the Council for a premises licence to sell some alcohol 7am to 11pm daily.

The shop will continue to be a general convenience store/post office selling a wide range of goods including newspapers, magazines, bread, milk, sweets, dairy, soft drinks, cigarettes, etc. The alcohol sales would just be a part of the overall business.

The law requires licensed premises to promote the 4 licensing objectives which are; the prevention of crime and disorder, public safety, prevention of public nuisance and the protection of children from harm.

My application shows all the steps that I would take to promote these objectives including CCTV, regular staff training, Challenge 25 underage sales policy, etc. I attach a copy of my proposed licence conditions for your information. I will do everything I can to make sure that local residents are not in any way disturbed by my shop.

I would be grateful if you would complete the brief form below please. If you have any queries or concerns please don't hesitate to let me know, or contact the Council direct.

Thanks

Lijo Thomas (owner)

To; Bury Council Licensing, 3 Knowsley Place, Duke St, Bury BL9 0EJ

Application for a premises licence – 2a The Parade, Rufford Drive, M45 8PL

I support this application for a premises licence

I wish to object to this application

Comments/reasons (please continue on a separate sheet if necessary)

.....
.....
.....
.....

NAME SHEHADA AHMED SIGNED [Signature]

ADDRESS 24 GLOUCESTER AVENUE, WHITEFIELD
M45 6BX

Dear Sir/Madam

**APPLICATION FOR A PREMISES LICENCE
SHOP AT 2A THE PARADE, RUFFORD DRIVE, WHITEFIELD M45 8PL**

As you may be aware, I have recently taken over the shop and have applied to the Council for a premises licence to sell some alcohol 7am to 11pm daily.

The shop will continue to be a general convenience store/post office selling a wide range of goods including newspapers, magazines, bread, milk, sweets, dairy, soft drinks, cigarettes, etc. The alcohol sales would just be a part of the overall business.

The law requires licensed premises to promote the 4 licensing objectives which are; the prevention of crime and disorder, public safety, prevention of public nuisance and the protection of children from harm.

My application shows all the steps that I would take to promote these objectives including CCTV, regular staff training, Challenge 25 underage sales policy, etc. I attach a copy of my proposed licence conditions for your information. I will do everything I can to make sure that local residents are not in any way disturbed by my shop.

I would be grateful if you would complete the brief form below please. If you have any queries or concerns please don't hesitate to let me know, or contact the Council direct.

Thanks

Lijo Thomas (owner)

To; Bury Council Licensing, 3 Knowsley Place, Duke St, Bury BL9 0EJ

Application for a premises licence – 2a The Parade, Rufford Drive, M45 8PL

I support this application for a premises licence

I wish to object to this application

Comments/reasons (please continue on a separate sheet if necessary)

..... I support
.....
.....

NAME MANUEL SIGNED [Signature]

ADDRESS 2a Gloucester avenue M45 8PL

Dear Sir/Madam

**APPLICATION FOR A PREMISES LICENCE
SHOP AT 2A THE PARADE, RUFFORD DRIVE, WHITEFIELD M45 8PL**

As you may be aware, I have recently taken over the shop and have applied to the Council for a premises licence to sell some alcohol 7am to 11pm daily.

The shop will continue to be a general convenience store/post office selling a wide range of goods including newspapers, magazines, bread, milk, sweets, dairy, soft drinks, cigarettes, etc. The alcohol sales would just be a part of the overall buisness.

The law requires licensed premises to promote the 4 licensing objectives which are; the prevention of crime and disorder, public safety, prevention of public nuisance and the protection of children from harm.

My application shows all the steps that I would take to promote these objectives including CCTV, regular staff training, Challenge 25 underage sales policy, etc. I attach a copy of my proposed licence conditions for your information. I will do everything I can to make sure that local residents are not in any way disturbed by my shop.

I would be grateful if you would complete the brief form below please. If you have any queries or concerns please don't hesitate to let me know, or contact the Council direct.

Thanks

Lijo Thomas (owner)

To; Bury Council Licensing, 3 Knowsley Place, Duke St, Bury BL9 0EJ

Application for a premises licence – 2a The Parade, Rufford Drive, M45 8PL

I support this application for a premises licence

I wish to object to this application

Comments/reasons (please continue on a separate sheet if necessary)

Good Shop and I'm sure they
will be able to control alcohol
Sales safely.

NAME D THORNTON SIGNED 

ADDRESS 4 GRAMSON AVE
M45 8HB

Dear Sir/Madam

**APPLICATION FOR A PREMISES LICENCE
SHOP AT 2A THE PARADE, RUFFORD DRIVE, WHITEFIELD M45 8PL**

As you may be aware, I have recently taken over the shop and have applied to the Council for a premises licence to sell some alcohol 7am to 11pm daily.

The shop will continue to be a general convenience store/post office selling a wide range of goods including newspapers, magazines, bread, milk, sweets, dairy, soft drinks, cigarettes, etc. The alcohol sales would just be a part of the overall business.

The law requires licensed premises to promote the 4 licensing objectives which are; the prevention of crime and disorder, public safety, prevention of public nuisance and the protection of children from harm.

My application shows all the steps that I would take to promote these objectives including CCTV, regular staff training, Challenge 25 underage sales policy, etc. I attach a copy of my proposed licence conditions for your information. I will do everything I can to make sure that local residents are not in any way disturbed by my shop.

I would be grateful if you would complete the brief form below please. If you have any queries or concerns please don't hesitate to let me know, or contact the Council direct.

Thanks

Lijo Thomas (owner)

To; Bury Council Licensing, 3 Knowsley Place, Duke St, Bury BL9 0EJ

Application for a premises licence – 2a The Parade, Rufford Drive, M45 8PL

I support this application for a premises licence

I wish to object to this application

Comments/reasons (please continue on a separate sheet if necessary)

I use this shop most days and they are a great asset to the area.

NAME Nathan Thornton SIGNED N. Thornton
ADDRESS 4 Grayson Avenue Bury M45 8HD

Dear Sir/Madam

**APPLICATION FOR A PREMISES LICENCE
SHOP AT 2A THE PARADE, RUFFORD DRIVE, WHITEFIELD M45 8PL**

As you may be aware, I have recently taken over the shop and have applied to the Council for a premises licence to sell some alcohol 7am to 11pm daily.

The shop will continue to be a general convenience store/post office selling a wide range of goods including newspapers, magazines, bread, milk, sweets, dairy, soft drinks, cigarettes, etc. The alcohol sales would just be a part of the overall buisness.

The law requires licensed premises to promote the 4 licensing objectives which are; the prevention of crime and disorder, public safety, prevention of public nuisance and the protection of children from harm.

My application shows all the steps that I would take to promote these objectives including CCTV, regular staff training, Challenge 25 underage sales policy, etc. I attach a copy of my proposed licence conditions for your information. I will do everything I can to make sure that local residents are not in any way disturbed by my shop.

I would be grateful if you would complete the brief form below please. If you have any queries or concerns please don't hesitate to let me know, or contact the Council direct.

Thanks

Lijo Thomas (owner)

To; Bury Council Licensing, 3 Knowsley Place, Duke St, Bury BL9 0EJ

Application for a premises licence – 2a The Parade, Rufford Drive, M45 8PL

I support this application for a premises licence

I wish to object to this application

Comments/reasons (please continue on a separate sheet if necessary)

I use this Shop a lot and they are very good at providing a local service and I think small business should be given a chance.

NAME Angela Thornton SIGNED A. Thornton

ADDRESS 4 GRAYSON AVE, Whitefield
M45 8HB.

Dear Sir/Madam

**APPLICATION FOR A PREMISES LICENCE
SHOP AT 2A THE PARADE, RUFFORD DRIVE, WHITEFIELD M45 8PL**

As you may be aware, I have recently taken over the shop and have applied to the Council for a premises licence to sell some alcohol 7am to 11pm daily.

The shop will continue to be a general convenience store/post office selling a wide range of goods including newspapers, magazines, bread, milk, sweets, dairy, soft drinks, cigarettes, etc. The alcohol sales would just be a part of the overall business.

The law requires licensed premises to promote the 4 licensing objectives which are; the prevention of crime and disorder, public safety, prevention of public nuisance and the protection of children from harm.

My application shows all the steps that I would take to promote these objectives including CCTV, regular staff training, Challenge 25 underage sales policy, etc. I attach a copy of my proposed licence conditions for your information. I will do everything I can to make sure that local residents are not in any way disturbed by my shop.

I would be grateful if you would complete the brief form below please. If you have any queries or concerns please don't hesitate to let me know, or contact the Council direct.

Thanks

Lijo Thomas (owner)

To; Bury Council Licensing, 3 Knowsley Place, Duke St, Bury BL9 0EJ

Application for a premises licence – 2a The Parade, Rufford Drive, M45 8PL

I support this application for a premises licence

I wish to object to this application

Comments/reasons (please continue on a separate sheet if necessary)

.....
.....
.....

.....
NAME ZARA NUTT SIGNED Z. Nutt
ADDRESS 1 Grosvenor Ave, M45 6GN
.....



Dear Sir/Madam

**APPLICATION FOR A PREMISES LICENCE
SHOP AT 2A THE PARADE, RUFFORD DRIVE, WHITEFIELD M45 8PL**

As you may be aware, I have recently taken over the shop and have applied to the Council for a premises licence to sell some alcohol 7am to 11pm daily.

The shop will continue to be a general convenience store/post office selling a wide range of goods including newspapers, magazines, bread, milk, sweets, dairy, soft drinks, cigarettes, etc. The alcohol sales would just be a part of the overall business.

The law requires licensed premises to promote the 4 licensing objectives which are; the prevention of crime and disorder, public safety, prevention of public nuisance and the protection of children from harm.

My application shows all the steps that I would take to promote these objectives including CCTV, regular staff training, Challenge 25 underage sales policy, etc. I attach a copy of my proposed licence conditions for your information. I will do everything I can to make sure that local residents are not in any way disturbed by my shop.

I would be grateful if you would complete the brief form below please. If you have any queries or concerns please don't hesitate to let me know, or contact the Council direct.

Thanks

Lijo Thomas (owner)

To; Bury Council Licensing, 3 Knowsley Place, Duke St, Bury BL9 0EJ

Application for a premises licence – 2a The Parade, Rufford Drive, M45 8PL

I support this application for a premises licence

I wish to object to this application

Comments/reasons (please continue on a separate sheet if necessary)

.....
.....
.....
.....

NAME MARION JANKOWSKI SIGNED [Signature]

ADDRESS RUFFORD DRIVE 2A, M45 8PL



Dear Sir/Madam

**APPLICATION FOR A PREMISES LICENCE
SHOP AT 2A THE PARADE, RUFFORD DRIVE, WHITEFIELD M45 8PL**

As you may be aware, I have recently taken over the shop and have applied to the Council for a premises licence to sell some alcohol 7am to 11pm daily.

The shop will continue to be a general convenience store/post office selling a wide range of goods including newspapers, magazines, bread, milk, sweets, dairy, soft drinks, cigarettes, etc. The alcohol sales would just be a part of the overall business.

The law requires licensed premises to promote the 4 licensing objectives which are; the prevention of crime and disorder, public safety, prevention of public nuisance and the protection of children from harm.

My application shows all the steps that I would take to promote these objectives including CCTV, regular staff training, Challenge 25 underage sales policy, etc. I attach a copy of my proposed licence conditions for your information. I will do everything I can to make sure that local residents are not in any way disturbed by my shop.

I would be grateful if you would complete the brief form below please. If you have any queries or concerns please don't hesitate to let me know, or contact the Council direct.

Thanks

Lijo Thomas (owner)

To; Bury Council Licensing, 3 Knowsley Place, Duke St, Bury BL9 0EJ

Application for a premises licence – 2a The Parade, Rufford Drive, M45 8PL

I support this application for a premises licence

I wish to object to this application

Comments/reasons (please continue on a separate sheet if necessary)
.....
.....
.....
.....

NAME *M. Thomas* SIGNED *M. Thomas*

ADDRESS *6 Sandley Drive* *Whitefield*

M45 - 8PL



Dear Sir/Madam

**APPLICATION FOR A PREMISES LICENCE
SHOP AT 2A THE PARADE, RUFFORD DRIVE, WHITEFIELD M45 8PL**

As you may be aware, I have recently taken over the shop and have applied to the Council for a premises licence to sell some alcohol 7am to 11pm daily.

The shop will continue to be a general convenience store/post office selling a wide range of goods including newspapers, magazines, bread, milk, sweets, dairy, soft drinks, cigarettes, etc. The alcohol sales would just be a part of the overall buisness.

The law requires licensed premises to promote the 4 licensing objectives which are; the prevention of crime and disorder, public safety, prevention of public nuisance and the protection of children from harm.

My application shows all the steps that I would take to promote these objectives including CCTV, regular staff training, Challenge 25 underage sales policy, etc. I attach a copy of my proposed licence conditions for your information. I will do everything I can to make sure that local residents are not in any way disturbed by my shop.

I would be grateful if you would complete the brief form below please. If you have any queries or concerns please don't hesitate to let me know, or contact the Council direct.

Thanks

Lijo Thomas (owner)

To; Bury Council Licensing, 3 Knowsley Place, Duke St, Bury BL9 0EJ

Application for a premises licence – 2a The Parade, Rufford Drive, M45 8PL

I support this application for a premises licence

I wish to object to this application

Comments/reasons (please continue on a separate sheet if necessary)

.....
.....
.....
.....

NAME *Bijl Thomas* SIGNED *[Signature]*

ADDRESS *2 Knowsley Pl.* *M45 8PL*

Dear Sir/Madam

**APPLICATION FOR A PREMISES LICENCE
SHOP AT 2A THE PARADE, RUFFORD DRIVE, WHITEFIELD M45 8PL**

As you may be aware, I have recently taken over the shop and have applied to the Council for a premises licence to sell some alcohol 7am to 11pm daily.

The shop will continue to be a general convenience store/post office selling a wide range of goods including newspapers, magazines, bread, milk, sweets, dairy, soft drinks, cigarettes, etc. The alcohol sales would just be a part of the overall business.

The law requires licensed premises to promote the 4 licensing objectives which are; the prevention of crime and disorder, public safety, prevention of public nuisance and the protection of children from harm.

My application shows all the steps that I would take to promote these objectives including CCTV, regular staff training, Challenge 25 underage sales policy, etc. I attach a copy of my proposed licence conditions for your information. I will do everything I can to make sure that local residents are not in any way disturbed by my shop.

I would be grateful if you would complete the brief form below please. If you have any queries or concerns please don't hesitate to let me know, or contact the Council direct.

Thanks

Lijo Thomas (owner)

To; Bury Council Licensing, 3 Knowsley Place, Duke St, Bury BL9 0EJ

Application for a premises licence – 2a The Parade, Rufford Drive, M45 8PL

I support this application for a premises licence

I wish to object to this application

Comments/reasons (please continue on a separate sheet if necessary)

.....
.....
.....
.....

NAME HELEN TORDOFF SIGNED 

ADDRESS 20 ABINGDON CLOSE, M45 8PU



Dear Sir/Madam

**APPLICATION FOR A PREMISES LICENCE
SHOP AT 2A THE PARADE, RUFFORD DRIVE, WHITEFIELD M45 8PL**

As you may be aware, I have recently taken over the shop and have applied to the Council for a premises licence to sell some alcohol 7am to 11pm daily.

The shop will continue to be a general convenience store/post office selling a wide range of goods including newspapers, magazines, bread, milk, sweets, dairy, soft drinks, cigarettes, etc. The alcohol sales would just be a part of the overall business.

The law requires licensed premises to promote the 4 licensing objectives which are; the prevention of crime and disorder, public safety, prevention of public nuisance and the protection of children from harm.

My application shows all the steps that I would take to promote these objectives including CCTV, regular staff training, Challenge 25 underage sales policy, etc. I attach a copy of my proposed licence conditions for your information. I will do everything I can to make sure that local residents are not in any way disturbed by my shop.

I would be grateful if you would complete the brief form below please. If you have any queries or concerns please don't hesitate to let me know, or contact the Council direct.

Thanks

Lijo Thomas (owner)

To; Bury Council Licensing, 3 Knowsley Place, Duke St, Bury BL9 0EJ

Application for a premises licence – 2a The Parade, Rufford Drive, M45 8PL

I support this application for a premises licence

I wish to object to this application

Comments/reasons (please continue on a separate sheet if necessary)

.....
.....
.....
.....

NAME MRS. EM TWAMLEY SIGNED EM Twamley

ADDRESS 4 STAWLEY ST WHITEFIELD M45 8GJ



Dear Sir/Madam

**APPLICATION FOR A PREMISES LICENCE
SHOP AT 2A THE PARADE, RUFFORD DRIVE, WHITEFIELD M45 8PL**

As you may be aware, I have recently taken over the shop and have applied to the Council for a premises licence to sell some alcohol 7am to 11pm daily.

The shop will continue to be a general convenience store/post office selling a wide range of goods including newspapers, magazines, bread, milk, sweets, dairy, soft drinks, cigarettes, etc. The alcohol sales would just be a part of the overall business.

The law requires licensed premises to promote the 4 licensing objectives which are; the prevention of crime and disorder, public safety, prevention of public nuisance and the protection of children from harm.

My application shows all the steps that I would take to promote these objectives including CCTV, regular staff training, Challenge 25 underage sales policy, etc. I attach a copy of my proposed licence conditions for your information. I will do everything I can to make sure that local residents are not in any way disturbed by my shop.

I would be grateful if you would complete the brief form below please. If you have any queries or concerns please don't hesitate to let me know, or contact the Council direct.

Thanks

Lijo Thomas (owner)

To; Bury Council Licensing, 3 Knowsley Place, Duke St, Bury BL9 0EJ

Application for a premises licence – 2a The Parade, Rufford Drive, M45 8PL

I support this application for a premises licence

I wish to object to this application

Comments/reasons (please continue on a separate sheet if necessary)

.....
.....
.....

NAME Lijo Thomas SIGNED Lijo Thomas
ADDRESS 2a Rufford Dr



Dear Sir/Madam

**APPLICATION FOR A PREMISES LICENCE
SHOP AT 2A THE PARADE, RUFFORD DRIVE, WHITEFIELD M45 8PL**

As you may be aware, I have recently taken over the shop and have applied to the Council for a premises licence to sell some alcohol 7am to 11pm daily.

The shop will continue to be a general convenience store/post office selling a wide range of goods including newspapers, magazines, bread, milk, sweets, dairy, soft drinks, cigarettes, etc. The alcohol sales would just be a part of the overall buisness.

The law requires licensed premises to promote the 4 licensing objectives which are; the prevention of crime and disorder, public safety, prevention of public nuisance and the protection of children from harm.

My application shows all the steps that I would take to promote these objectives including CCTV, regular staff training, Challenge 25 underage sales policy, etc. I attach a copy of my proposed licence conditions for your information. I will do everything I can to make sure that local residents are not in any way disturbed by my shop.

I would be grateful if you would complete the brief form below please. If you have any queries or concerns please don't hesitate to let me know, or contact the Council direct.

Thanks

Lijo Thomas (owner)

To; Bury Council Licensing, 3 Knowsley Place, Duke St, Bury BL9 0EJ

Application for a premises licence – 2a The Parade, Rufford Drive, M45 8PL

I support this application for a premises licence

I wish to object to this application

Comments/reasons (please continue on a separate sheet if necessary)

.....
.....
.....
.....

NAME A MATT SIGNED [Signature]

ADDRESS 4 GARDEN AVE M45 8PL



Dear Sir/Madam

**APPLICATION FOR A PREMISES LICENCE
SHOP AT 2A THE PARADE, RUFFORD DRIVE, WHITEFIELD M45 8PL**

As you may be aware, I have recently taken over the shop and have applied to the Council for a premises licence to sell some alcohol 7am to 11pm daily.

The shop will continue to be a general convenience store/post office selling a wide range of goods including newspapers, magazines, bread, milk, sweets, dairy, soft drinks, cigarettes, etc. The alcohol sales would just be a part of the overall buisness.

The law requires licensed premises to promote the 4 licensing objectives which are; the prevention of crime and disorder, public safety, prevention of public nuisance and the protection of children from harm.

My application shows all the steps that I would take to promote these objectives including CCTV, regular staff training, Challenge 25 underage sales policy, etc. I attach a copy of my proposed licence conditions for your information. I will do everything I can to make sure that local residents are not in any way disturbed by my shop.

I would be grateful if you would complete the brief form below please. If you have any queries or concerns please don't hesitate to let me know, or contact the Council direct.

Thanks

Lijo Thomas (owner)

To; Bury Council Licensing, 3 Knowsley Place, Duke St, Bury BL9 0EJ

Application for a premises licence – 2a The Parade, Rufford Drive, M45 8PL

I support this application for a premises licence

I wish to object to this application

Comments/reasons (please continue on a separate sheet if necessary)

NAME BOBBY CHAPMAN SIGNED..... [Signature]

ADDRESS..... 29 WHALLEY RD M45 8PA



Dear Sir/Madam

**APPLICATION FOR A PREMISES LICENCE
SHOP AT 2A THE PARADE, RUFFORD DRIVE, WHITEFIELD M45 8PL**

As you may be aware, I have recently taken over the shop and have applied to the Council for a premises licence to sell some alcohol 7am to 11pm daily.

The shop will continue to be a general convenience store/post office selling a wide range of goods including newspapers, magazines, bread, milk, sweets, dairy, soft drinks, cigarettes, etc. The alcohol sales would just be a part of the overall buisness.

The law requires licensed premises to promote the 4 licensing objectives which are; the prevention of crime and disorder, public safety, prevention of public nuisance and the protection of children from harm.

My application shows all the steps that I would take to promote these objectives including CCTV, regular staff training, Challenge 25 underage sales policy, etc. I attach a copy of my proposed licence conditions for your information. I will do everything I can to make sure that local residents are not in any way disturbed by my shop.

I would be grateful if you would complete the brief form below please. If you have any queries or concerns please don't hesitate to let me know, or contact the Council direct.

Thanks

Lijo Thomas (owner)

To; Bury Council Licensing, 3 Knowsley Place, Duke St, Bury BL9 0EJ

Application for a premises licence – 2a The Parade, Rufford Drive, M45 8PL

I support this application for a premises licence

I wish to object to this application

Comments/reasons (please continue on a separate sheet if necessary)

.....
.....
.....
.....

NAME ROBERT CHAPMAN SIGNED [Signature]

ADDRESS 29 WHALLEY RD WHITEFIELD M45 8PA

Dear Sir/Madam

**APPLICATION FOR A PREMISES LICENCE
SHOP AT 2A THE PARADE, RUFFORD DRIVE, WHITEFIELD M45 8PL**

As you may be aware, I have recently taken over the shop and have applied to the Council for a premises licence to sell some alcohol 7am to 11pm daily.

The shop will continue to be a general convenience store/post office selling a wide range of goods including newspapers, magazines, bread, milk, sweets, dairy, soft drinks, cigarettes, etc. The alcohol sales would just be a part of the overall buisness.

The law requires licensed premises to promote the 4 licensing objectives which are; the prevention of crime and disorder, public safety, prevention of public nuisance and the protection of children from harm.

My application shows all the steps that I would take to promote these objectives including CCTV, regular staff training, Challenge 25 underage sales policy, etc. I attach a copy of my proposed licence conditions for your information. I will do everything I can to make sure that local residents are not in any way disturbed by my shop.

I would be grateful if you would complete the brief form below please. If you have any queries or concerns please don't hesitate to let me know, or contact the Council direct.

Thanks

Lijo Thomas (owner)

To; Bury Council Licensing, 3 Knowsley Place, Duke St, Bury BL9 0EJ

Application for a premises licence – 2a The Parade, Rufford Drive, M45 8PL

I support this application for a premises licence

I wish to object to this application

Comments/reasons (please continue on a separate sheet if necessary)

.....
.....
.....
.....

NAME Sarah Wyatt SIGNED [Signature]

ADDRESS 7 Lind Avenue Radcliffe

Dear Sir/Madam

**APPLICATION FOR A PREMISES LICENCE
SHOP AT 2A THE PARADE, RUFFORD DRIVE, WHITEFIELD M45 8PL**

As you may be aware, I have recently taken over the shop and have applied to the Council for a premises licence to sell some alcohol 7am to 11pm daily.

The shop will continue to be a general convenience store/post office selling a wide range of goods including newspapers, magazines, bread, milk, sweets, dairy, soft drinks, cigarettes, etc. The alcohol sales would just be a part of the overall business.

The law requires licensed premises to promote the 4 licensing objectives which are; the prevention of crime and disorder, public safety, prevention of public nuisance and the protection of children from harm.

My application shows all the steps that I would take to promote these objectives including CCTV, regular staff training, Challenge 25 underage sales policy, etc. I attach a copy of my proposed licence conditions for your information. I will do everything I can to make sure that local residents are not in any way disturbed by my shop.

I would be grateful if you would complete the brief form below please. If you have any queries or concerns please don't hesitate to let me know, or contact the Council direct.

Thanks

Lijo Thomas (owner)

To; Bury Council Licensing, 3 Knowsley Place, Duke St, Bury BL9 0EJ

Application for a premises licence – 2a The Parade, Rufford Drive, M45 8PL

I support this application for a premises licence

I wish to object to this application

Comments/reasons (please continue on a separate sheet if necessary)

.....
.....
.....
.....

NAME ALBERT SIGNED..... [Signature]

ADDRESS..... 2A PARADE M45 8PL

Dear Sir/Madam

**APPLICATION FOR A PREMISES LICENCE
SHOP AT 2A THE PARADE, RUFFORD DRIVE, WHITEFIELD M45 8PL**

As you may be aware, I have recently taken over the shop and have applied to the Council for a premises licence to sell some alcohol 7am to 11pm daily.

The shop will continue to be a general convenience store/post office selling a wide range of goods including newspapers, magazines, bread, milk, sweets, dairy, soft drinks, cigarettes, etc. The alcohol sales would just be a part of the overall buisness.

The law requires licensed premises to promote the 4 licensing objectives which are; the prevention of crime and disorder, public safety, prevention of public nuisance and the protection of children from harm.

My application shows all the steps that I would take to promote these objectives including CCTV, regular staff training, Challenge 25 underage sales policy, etc. I attach a copy of my proposed licence conditions for your information. I will do everything I can to make sure that local residents are not in any way disturbed by my shop.

I would be grateful if you would complete the brief form below please. If you have any queries or concerns please don't hesitate to let me know, or contact the Council direct.

Thanks

Lijo Thomas (owner)

To; Bury Council Licensing, 3 Knowsley Place, Duke St, Bury BL9 0EJ

Application for a premises licence – 2a The Parade, Rufford Drive, M45 8PL

I support this application for a premises licence

I wish to object to this application

Comments/reasons (please continue on a separate sheet if necessary)

.....
.....
.....
.....

NAME Scott SIGNED [Signature]

ADDRESS 7 Laurel Avenue Radcliffe

Dear Sir/Madam

**APPLICATION FOR A PREMISES LICENCE
SHOP AT 2A THE PARADE, RUFFORD DRIVE, WHITEFIELD M45 8PL**

As you may be aware, I have recently taken over the shop and have applied to the Council for a premises licence to sell some alcohol 7am to 11pm daily.

The shop will continue to be a general convenience store/post office selling a wide range of goods including newspapers, magazines, bread, milk, sweets, dairy, soft drinks, cigarettes, etc. The alcohol sales would just be a part of the overall business.

The law requires licensed premises to promote the 4 licensing objectives which are; the prevention of crime and disorder, public safety, prevention of public nuisance and the protection of children from harm.

My application shows all the steps that I would take to promote these objectives including CCTV, regular staff training, Challenge 25 underage sales policy, etc. I attach a copy of my proposed licence conditions for your information. I will do everything I can to make sure that local residents are not in any way disturbed by my shop.

I would be grateful if you would complete the brief form below please. If you have any queries or concerns please don't hesitate to let me know, or contact the Council direct.

Thanks

Lijo Thomas (owner)

To; Bury Council Licensing, 3 Knowsley Place, Duke St, Bury BL9 0EJ

Application for a premises licence – 2a The Parade, Rufford Drive, M45 8PL

I support this application for a premises licence

I wish to object to this application

Comments/reasons (please continue on a separate sheet if necessary)

.....
.....
.....

NAME S. THOMAS SIGNED [Signature]

ADDRESS 2A PARADE M45 8PL

Dear Sir/Madam

**APPLICATION FOR A PREMISES LICENCE
SHOP AT 2A THE PARADE, RUFFORD DRIVE, WHITEFIELD M45 8PL**

As you may be aware, I have recently taken over the shop and have applied to the Council for a premises licence to sell some alcohol 7am to 11pm daily.

The shop will continue to be a general convenience store/post office selling a wide range of goods including newspapers, magazines, bread, milk, sweets, dairy, soft drinks, cigarettes, etc. The alcohol sales would just be a part of the overall business.

The law requires licensed premises to promote the 4 licensing objectives which are; the prevention of crime and disorder, public safety, prevention of public nuisance and the protection of children from harm.

My application shows all the steps that I would take to promote these objectives including CCTV, regular staff training, Challenge 25 underage sales policy, etc. I attach a copy of my proposed licence conditions for your information. I will do everything I can to make sure that local residents are not in any way disturbed by my shop.

I would be grateful if you would complete the brief form below please. If you have any queries or concerns please don't hesitate to let me know, or contact the Council direct.

Thanks

Lijo Thomas (owner)

To; Bury Council Licensing, 3 Knowsley Place, Duke St, Bury BL9 0EJ

Application for a premises licence – 2a The Parade, Rufford Drive, M45 8PL

I support this application for a premises licence

I wish to object to this application

Comments/reasons (please continue on a separate sheet if necessary)

.....
.....
.....
.....

NAME SADJAD ROBANI SIGNED 

ADDRESS 381 PRINCESS RD



Dear Sir/Madam

**APPLICATION FOR A PREMISES LICENCE
SHOP AT 2A THE PARADE, RUFFORD DRIVE, WHITEFIELD M45 8PL**

As you may be aware, I have recently taken over the shop and have applied to the Council for a premises licence to sell some alcohol 7am to 11pm daily.

The shop will continue to be a general convenience store/post office selling a wide range of goods including newspapers, magazines, bread, milk, sweets, dairy, soft drinks, cigarettes, etc. The alcohol sales would just be a part of the overall buisness.

The law requires licensed premises to promote the 4 licensing objectives which are; the prevention of crime and disorder, public safety, prevention of public nuisance and the protection of children from harm.

My application shows all the steps that I would take to promote these objectives including CCTV, regular staff training, Challenge 25 underage sales policy, etc. I attach a copy of my proposed licence conditions for your information. I will do everything I can to make sure that local residents are not in any way disturbed by my shop.

I would be grateful if you would complete the brief form below please. If you have any queries or concerns please don't hesitate to let me know, or contact the Council direct.

Thanks

Lijo Thomas (owner)

To; Bury Council Licensing, 3 Knowsley Place, Duke St, Bury BL9 0EJ

Application for a premises licence – 2a The Parade, Rufford Drive, M45 8PL

I support this application for a premises licence

I wish to object to this application

Comments/reasons (please continue on a separate sheet if necessary)

.....
.....
.....
.....

NAME *LIJO THOMAS* SIGNED *[Signature]*

ADDRESS *20 VICTORIA AVE* *WHITEFIELD* *M45 6DP*



Dear Sir/Madam

**APPLICATION FOR A PREMISES LICENCE
SHOP AT 2A THE PARADE, RUFFORD DRIVE, WHITEFIELD M45 8PL**

As you may be aware, I have recently taken over the shop and have applied to the Council for a premises licence to sell some alcohol 7am to 11pm daily.

The shop will continue to be a general convenience store/post office selling a wide range of goods including newspapers, magazines, bread, milk, sweets, dairy, soft drinks, cigarettes, etc. The alcohol sales would just be a part of the overall business.

The law requires licensed premises to promote the 4 licensing objectives which are; the prevention of crime and disorder, public safety, prevention of public nuisance and the protection of children from harm.

My application shows all the steps that I would take to promote these objectives including CCTV, regular staff training, Challenge 25 underage sales policy, etc. I attach a copy of my proposed licence conditions for your information. I will do everything I can to make sure that local residents are not in any way disturbed by my shop.

I would be grateful if you would complete the brief form below please. If you have any queries or concerns please don't hesitate to let me know, or contact the Council direct.

Thanks

Lijo Thomas (owner)

To; Bury Council Licensing, 3 Knowsley Place, Duke St, Bury BL9 0EJ

Application for a premises licence – 2a The Parade, Rufford Drive, M45 8PL

I support this application for a premises licence

I wish to object to this application

Comments/reasons (please continue on a separate sheet if necessary)

.....
.....
.....

NAME Scott SIGNED S Potteet

ADDRESS 26 wclbeck close



Dear Sir/Madam

**APPLICATION FOR A PREMISES LICENCE
SHOP AT 2A THE PARADE, RUFFORD DRIVE, WHITEFIELD M45 8PL**

As you may be aware, I have recently taken over the shop and have applied to the Council for a premises licence to sell some alcohol 7am to 11pm daily.

The shop will continue to be a general convenience store/post office selling a wide range of goods including newspapers, magazines, bread, milk, sweets, dairy, soft drinks, cigarettes, etc. The alcohol sales would just be a part of the overall business.

The law requires licensed premises to promote the 4 licensing objectives which are; the prevention of crime and disorder, public safety, prevention of public nuisance and the protection of children from harm.

My application shows all the steps that I would take to promote these objectives including CCTV, regular staff training, Challenge 25 underage sales policy, etc. I attach a copy of my proposed licence conditions for your information. I will do everything I can to make sure that local residents are not in any way disturbed by my shop.

I would be grateful if you would complete the brief form below please. If you have any queries or concerns please don't hesitate to let me know, or contact the Council direct.

Thanks

Lijo Thomas (owner)

To; Bury Council Licensing, 3 Knowsley Place, Duke St, Bury BL9 0EJ

Application for a premises licence – 2a The Parade, Rufford Drive, M45 8PL

I support this application for a premises licence

I wish to object to this application

Comments/reasons (please continue on a separate sheet if necessary)

NAME *Robinson* SIGNED *[Signature]*

ADDRESS *27 Knowsley Road*



Dear Sir/Madam

**APPLICATION FOR A PREMISES LICENCE
SHOP AT 2A THE PARADE, RUFFORD DRIVE, WHITEFIELD M45 8PL**

As you may be aware, I have recently taken over the shop and have applied to the Council for a premises licence to sell some alcohol 7am to 11pm daily.

The shop will continue to be a general convenience store/post office selling a wide range of goods including newspapers, magazines, bread, milk, sweets, dairy, soft drinks, cigarettes, etc. The alcohol sales would just be a part of the overall buisness.

The law requires licensed premises to promote the 4 licensing objectives which are; the prevention of crime and disorder, public safety, prevention of public nuisance and the protection of children from harm.

My application shows all the steps that I would take to promote these objectives including CCTV, regular staff training, Challenge 25 underage sales policy, etc. I attach a copy of my proposed licence conditions for your information. I will do everything I can to make sure that local residents are not in any way disturbed by my shop.

I would be grateful if you would complete the brief form below please. If you have any queries or concerns please don't hesitate to let me know, or contact the Council direct.

Thanks

Lijo Thomas (owner)

To; Bury Council Licensing, 3 Knowsley Place, Duke St, Bury BL9 0EJ

Application for a premises licence – 2a The Parade, Rufford Drive, M45 8PL

I support this application for a premises licence

I wish to object to this application

Comments/reasons (please continue on a separate sheet if necessary)

.....
.....
.....
.....

NAME ABDUS SALAM SIGNED [Signature]

ADDRESS 30 VICTORIA AVE
WHITEFIELD M45-6DP



Dear Sir/Madam

**APPLICATION FOR A PREMISES LICENCE
SHOP AT 2A THE PARADE, RUFFORD DRIVE, WHITEFIELD M45 8PL**

As you may be aware, I have recently taken over the shop and have applied to the Council for a premises licence to sell some alcohol 7am to 11pm daily.

The shop will continue to be a general convenience store/post office selling a wide range of goods including newspapers, magazines, bread, milk, sweets, dairy, soft drinks, cigarettes, etc. The alcohol sales would just be a part of the overall buisness.

The law requires licensed premises to promote the 4 licensing objectives which are; the prevention of crime and disorder, public safety, prevention of public nuisance and the protection of children from harm.

My application shows all the steps that I would take to promote these objectives including CCTV, regular staff training, Challenge 25 underage sales policy, etc. I attach a copy of my proposed licence conditions for your information. I will do everything I can to make sure that local residents are not in any way disturbed by my shop.

I would be grateful if you would complete the brief form below please. If you have any queries or concerns please don't hesitate to let me know, or contact the Council direct.

Thanks

Lijo Thomas (owner)

To; Bury Council Licensing, 3 Knowsley Place, Duke St, Bury BL9 0EJ

Application for a premises licence – 2a The Parade, Rufford Drive, M45 8PL

I support this application for a premises licence

I wish to object to this application

Comments/reasons (please continue on a separate sheet if necessary)

.....

.....

.....

NAME J. L. P. E. SIGNED..... [Signature]

ADDRESS..... 30 Victoria Avenue Whitefield.

Dear Sir/Madam

**APPLICATION FOR A PREMISES LICENCE
SHOP AT 2A THE PARADE, RUFFORD DRIVE, WHITEFIELD M45 8PL**

As you may be aware, I have recently taken over the shop and have applied to the Council for a premises licence to sell some alcohol 7am to 11pm daily.

The shop will continue to be a general convenience store/post office selling a wide range of goods including newspapers, magazines, bread, milk, sweets, dairy, soft drinks, cigarettes, etc. The alcohol sales would just be a part of the overall buisness.

The law requires licensed premises to promote the 4 licensing objectives which are; the prevention of crime and disorder, public safety, prevention of public nuisance and the protection of children from harm.

My application shows all the steps that I would take to promote these objectives including CCTV, regular staff training, Challenge 25 underage sales policy, etc. I attach a copy of my proposed licence conditions for your information. I will do everything I can to make sure that local residents are not in any way disturbed by my shop.

I would be grateful if you would complete the brief form below please. If you have any queries or concerns please don't hesitate to let me know, or contact the Council direct.

Thanks

Lijo Thomas (owner)

To; Bury Council Licensing, 3 Knowsley Place, Duke St, Bury BL9 0EJ

Application for a premises licence – 2a The Parade, Rufford Drive, M45 8PL

I support this application for a premises licence

I wish to object to this application

Comments/reasons (please continue on a separate sheet if necessary)

.....
This shop is just what's needed round
here AFFORDABLE PRICES and
amazing staff
.....

NAME LISA ANKROD SIGNED [Signature]

ADDRESS 23 Rufford Drive
.....



Dear Sir/Madam

**APPLICATION FOR A PREMISES LICENCE
SHOP AT 2A THE PARADE, RUFFORD DRIVE, WHITEFIELD M45 8PL**

As you may be aware, I have recently taken over the shop and have applied to the Council for a premises licence to sell some alcohol 7am to 11pm daily.

The shop will continue to be a general convenience store/post office selling a wide range of goods including newspapers, magazines, bread, milk, sweets, dairy, soft drinks, cigarettes, etc. The alcohol sales would just be a part of the overall buisness.

The law requires licensed premises to promote the 4 licensing objectives which are; the prevention of crime and disorder, public safety, prevention of public nuisance and the protection of children from harm.

My application shows all the steps that I would take to promote these objectives including CCTV, regular staff training, Challenge 25 underage sales policy, etc. I attach a copy of my proposed licence conditions for your information. I will do everything I can to make sure that local residents are not in any way disturbed by my shop.

I would be grateful if you would complete the brief form below please. If you have any queries or concerns please don't hesitate to let me know, or contact the Council direct.

Thanks

Lijo Thomas (owner)

To; Bury Council Licensing, 3 Knowsley Place, Duke St, Bury BL9 0EJ

Application for a premises licence – 2a The Parade, Rufford Drive, M45 8PL

I support this application for a premises licence

I wish to object to this application

Comments/reasons (please continue on a separate sheet if necessary)

.....
.....
.....
.....

NAME SHARON SIGNED..... [Signature]

ADDRESS..... 2A Rufford Drive
Whitefield



Dear Sir/Madam

**APPLICATION FOR A PREMISES LICENCE
SHOP AT 2A THE PARADE, RUFFORD DRIVE, WHITEFIELD M45 8PL**

As you may be aware, I have recently taken over the shop and have applied to the Council for a premises licence to sell some alcohol 7am to 11pm daily.

The shop will continue to be a general convenience store/post office selling a wide range of goods including newspapers, magazines, bread, milk, sweets, dairy, soft drinks, cigarettes, etc. The alcohol sales would just be a part of the overall business.

The law requires licensed premises to promote the 4 licensing objectives which are; the prevention of crime and disorder, public safety, prevention of public nuisance and the protection of children from harm.

My application shows all the steps that I would take to promote these objectives including CCTV, regular staff training, Challenge 25 underage sales policy, etc. I attach a copy of my proposed licence conditions for your information. I will do everything I can to make sure that local residents are not in any way disturbed by my shop.

I would be grateful if you would complete the brief form below please. If you have any queries or concerns please don't hesitate to let me know, or contact the Council direct.

Thanks

Lijo Thomas (owner)

To; Bury Council Licensing, 3 Knowsley Place, Duke St, Bury BL9 0EJ

Application for a premises licence – 2a The Parade, Rufford Drive, M45 8PL

I support this application for a premises licence

I wish to object to this application

Comments/reasons (please continue on a separate sheet if necessary)

.....
.....
.....
.....

NAME *Lijo Thomas* SIGNED *Lijo Thomas*

ADDRESS *4a Rufford Drive*



Dear Sir/Madam

**APPLICATION FOR A PREMISES LICENCE
SHOP AT 2A THE PARADE, RUFFORD DRIVE, WHITEFIELD M45 8PL**

As you may be aware, I have recently taken over the shop and have applied to the Council for a premises licence to sell some alcohol 7am to 11pm daily.

The shop will continue to be a general convenience store/post office selling a wide range of goods including newspapers, magazines, bread, milk, sweets, dairy, soft drinks, cigarettes, etc. The alcohol sales would just be a part of the overall buisness.

The law requires licensed premises to promote the 4 licensing objectives which are; the prevention of crime and disorder, public safety, prevention of public nuisance and the protection of children from harm.

My application shows all the steps that I would take to promote these objectives including CCTV, regular staff training, Challenge 25 underage sales policy, etc. I attach a copy of my proposed licence conditions for your information. I will do everything I can to make sure that local residents are not in any way disturbed by my shop.

I would be grateful if you would complete the brief form below please. If you have any queries or concerns please don't hesitate to let me know, or contact the Council direct.

Thanks

Lijo Thomas (owner)

To; Bury Council Licensing, 3 Knowsley Place, Duke St, Bury BL9 0EJ

Application for a premises licence – 2a The Parade, Rufford Drive, M45 8PL

I support this application for a premises licence

I wish to object to this application

Comments/reasons (please continue on a separate sheet if necessary)

.....
.....
.....

NAME Thomas Lijo SIGNED [Signature]

ADDRESS 17 Rufford Drive Whitefield



Dear Sir/Madam

**APPLICATION FOR A PREMISES LICENCE
SHOP AT 2A THE PARADE, RUFFORD DRIVE, WHITEFIELD M45 8PL**

As you may be aware, I have recently taken over the shop and have applied to the Council for a premises licence to sell some alcohol 7am to 11pm daily.

The shop will continue to be a general convenience store/post office selling a wide range of goods including newspapers, magazines, bread, milk, sweets, dairy, soft drinks, cigarettes, etc. The alcohol sales would just be a part of the overall buisness.

The law requires licensed premises to promote the 4 licensing objectives which are; the prevention of crime and disorder, public safety, prevention of public nuisance and the protection of children from harm.

My application shows all the steps that I would take to promote these objectives including CCTV, regular staff training, Challenge 25 underage sales policy, etc. I attach a copy of my proposed licence conditions for your information. I will do everything I can to make sure that local residents are not in any way disturbed by my shop.

I would be grateful if you would complete the brief form below please. If you have any queries or concerns please don't hesitate to let me know, or contact the Council direct.

Thanks

Lijo Thomas (owner)

To; Bury Council Licensing, 3 Knowsley Place, Duke St, Bury BL9 0EJ

Application for a premises licence – 2a The Parade, Rufford Drive, M45 8PL

I support this application for a premises licence

I wish to object to this application

Comments/reasons (please continue on a separate sheet if necessary)

.....
.....
.....
.....

NAME Chris Holland SIGNED [Signature]

ADDRESS 8 38 Sawley Avenue Whitefield



Dear Sir/Madam

**APPLICATION FOR A PREMISES LICENCE
SHOP AT 2A THE PARADE, RUFFORD DRIVE, WHITEFIELD M45 8PL**

As you may be aware, I have recently taken over the shop and have applied to the Council for a premises licence to sell some alcohol 7am to 11pm daily.

The shop will continue to be a general convenience store/post office selling a wide range of goods including newspapers, magazines, bread, milk, sweets, dairy, soft drinks, cigarettes, etc. The alcohol sales would just be a part of the overall buisness.

The law requires licensed premises to promote the 4 licensing objectives which are; the prevention of crime and disorder, public safety, prevention of public nuisance and the protection of children from harm.

My application shows all the steps that I would take to promote these objectives including CCTV, regular staff training, Challenge 25 underage sales policy, etc. I attach a copy of my proposed licence conditions for your information. I will do everything I can to make sure that local residents are not in any way disturbed by my shop.

I would be grateful if you would complete the brief form below please. If you have any queries or concerns please don't hesitate to let me know, or contact the Council direct.

Thanks

Lijo Thomas (owner)

To; Bury Council Licensing, 3 Knowsley Place, Duke St, Bury BL9 0EJ

Application for a premises licence – 2a The Parade, Rufford Drive, M45 8PL

I support this application for a premises licence

I wish to object to this application

Comments/reasons (please continue on a separate sheet if necessary)

.....
.....
.....
.....

NAME Andrew Holland SIGNED A. Holland

ADDRESS 36 3 Sawley Avenue Whitefield



Dear Sir/Madam

**APPLICATION FOR A PREMISES LICENCE
SHOP AT 2A THE PARADE, RUFFORD DRIVE, WHITEFIELD M45 8PL**

As you may be aware, I have recently taken over the shop and have applied to the Council for a premises licence to sell some alcohol 7am to 11pm daily.

The shop will continue to be a general convenience store/post office selling a wide range of goods including newspapers, magazines, bread, milk, sweets, dairy, soft drinks, cigarettes, etc. The alcohol sales would just be a part of the overall buisness.

The law requires licensed premises to promote the 4 licensing objectives which are; the prevention of crime and disorder, public safety, prevention of public nuisance and the protection of children from harm.

My application shows all the steps that I would take to promote these objectives including CCTV, regular staff training, Challenge 25 underage sales policy, etc. I attach a copy of my proposed licence conditions for your information. I will do everything I can to make sure that local residents are not in any way disturbed by my shop.

I would be grateful if you would complete the brief form below please. If you have any queries or concerns please don't hesitate to let me know, or contact the Council direct.

Thanks

Lijo Thomas (owner)

To; Bury Council Licensing, 3 Knowsley Place, Duke St, Bury BL9 0EJ

Application for a premises licence – 2a The Parade, Rufford Drive, M45 8PL

I support this application for a premises licence

I wish to object to this application

Comments/reasons (please continue on a separate sheet if necessary)

.....
.....
.....

NAME Swietlana Kura SIGNED [Signature]

ADDRESS 4 Sawley Avenue m45 8PP



Dear Sir/Madam

**APPLICATION FOR A PREMISES LICENCE
SHOP AT 2A THE PARADE, RUFFORD DRIVE, WHITEFIELD M45 8PL**

As you may be aware, I have recently taken over the shop and have applied to the Council for a premises licence to sell some alcohol 7am to 11pm daily.

The shop will continue to be a general convenience store/post office selling a wide range of goods including newspapers, magazines, bread, milk, sweets, dairy, soft drinks, cigarettes, etc. The alcohol sales would just be a part of the overall business.

The law requires licensed premises to promote the 4 licensing objectives which are; the prevention of crime and disorder, public safety, prevention of public nuisance and the protection of children from harm.

My application shows all the steps that I would take to promote these objectives including CCTV, regular staff training, Challenge 25 underage sales policy, etc. I attach a copy of my proposed licence conditions for your information. I will do everything I can to make sure that local residents are not in any way disturbed by my shop.

I would be grateful if you would complete the brief form below please. If you have any queries or concerns please don't hesitate to let me know, or contact the Council direct.

Thanks

Lijo Thomas (owner)

To; Bury Council Licensing, 3 Knowsley Place, Duke St, Bury BL9 0EJ

Application for a premises licence – 2a The Parade, Rufford Drive, M45 8PL

I support this application for a premises licence

I wish to object to this application

Comments/reasons (please continue on a separate sheet if necessary)

I am visiting the post office mostly every week and it would be ideal for me to purchase Alcohol from here.

NAME Caroline Dixon SIGNED C. Dixon

ADDRESS 13 South Av Whitefield/mc



Dear Sir/Madam

**APPLICATION FOR A PREMISES LICENCE
SHOP AT 2A THE PARADE, RUFFORD DRIVE, WHITEFIELD M45 8PL**

As you may be aware, I have recently taken over the shop and have applied to the Council for a premises licence to sell some alcohol 7am to 11pm daily.

The shop will continue to be a general convenience store/post office selling a wide range of goods including newspapers, magazines, bread, milk, sweets, dairy, soft drinks, cigarettes, etc. The alcohol sales would just be a part of the overall buisness.

The law requires licensed premises to promote the 4 licensing objectives which are; the prevention of crime and disorder, public safety, prevention of public nuisance and the protection of children from harm.

My application shows all the steps that I would take to promote these objectives including CCTV, regular staff training, Challenge 25 underage sales policy, etc. I attach a copy of my proposed licence conditions for your information. I will do everything I can to make sure that local residents are not in any way disturbed by my shop.

I would be grateful if you would complete the brief form below please. If you have any queries or concerns please don't hesitate to let me know, or contact the Council direct.

Thanks

Lijo Thomas (owner)

To; Bury Council Licensing, 3 Knowsley Place, Duke St, Bury BL9 0EJ

Application for a premises licence – 2a The Parade, Rufford Drive, M45 8PL

I support this application for a premises licence

I wish to object to this application

Comments/reasons (please continue on a separate sheet if necessary)

.....
.....
.....

NAME LESLEY CHANUSAL SIGNED

ADDRESS 31 SPENCER AVE WHITEFIELD
M45 7RE



Dear Sir/Madam

**APPLICATION FOR A PREMISES LICENCE
SHOP AT 2A THE PARADE, RUFFORD DRIVE, WHITEFIELD M45 8PL**

As you may be aware, I have recently taken over the shop and have applied to the Council for a premises licence to sell some alcohol 7am to 11pm daily.

The shop will continue to be a general convenience store/post office selling a wide range of goods including newspapers, magazines, bread, milk, sweets, dairy, soft drinks, cigarettes, etc. The alcohol sales would just be a part of the overall buisness.

The law requires licensed premises to promote the 4 licensing objectives which are; the prevention of crime and disorder, public safety, prevention of public nuisance and the protection of children from harm.

My application shows all the steps that I would take to promote these objectives including CCTV, regular staff training, Challenge 25 underage sales policy, etc. I attach a copy of my proposed licence conditions for your information. I will do everything I can to make sure that local residents are not in any way disturbed by my shop.

I would be grateful if you would complete the brief form below please. If you have any queries or concerns please don't hesitate to let me know, or contact the Council direct.

Thanks

Lijo Thomas (owner)

To; Bury Council Licensing, 3 Knowsley Place, Duke St, Bury BL9 0EJ

Application for a premises licence – 2a The Parade, Rufford Drive, M45 8PL

I support this application for a premises licence

I wish to object to this application

Comments/reasons (please continue on a separate sheet if necessary)

.....
.....
.....
.....

NAME EMMA THOMAS SIGNED [Signature]

ADDRESS 7 THORP ST WHITEFIELD
M45 7TH



Dear Sir/Madam

**APPLICATION FOR A PREMISES LICENCE
SHOP AT 2A THE PARADE, RUFFORD DRIVE, WHITEFIELD M45 8PL**

As you may be aware, I have recently taken over the shop and have applied to the Council for a premises licence to sell some alcohol 7am to 11pm daily.

The shop will continue to be a general convenience store/post office selling a wide range of goods including newspapers, magazines, bread, milk, sweets, dairy, soft drinks, cigarettes, etc. The alcohol sales would just be a part of the overall business.

The law requires licensed premises to promote the 4 licensing objectives which are; the prevention of crime and disorder, public safety, prevention of public nuisance and the protection of children from harm.

My application shows all the steps that I would take to promote these objectives including CCTV, regular staff training, Challenge 25 underage sales policy, etc. I attach a copy of my proposed licence conditions for your information. I will do everything I can to make sure that local residents are not in any way disturbed by my shop.

I would be grateful if you would complete the brief form below please. If you have any queries or concerns please don't hesitate to let me know, or contact the Council direct.

Thanks

Lijo Thomas (owner)

To; Bury Council Licensing, 3 Knowsley Place, Duke St, Bury BL9 0EJ

Application for a premises licence – 2a The Parade, Rufford Drive, M45 8PL

I support this application for a premises licence

I wish to object to this application

Comments/reasons (please continue on a separate sheet if necessary)

.....
.....
.....

NAME *Anthony* SIGNED *Anthony*

ADDRESS *14 Thurston Close Whitefield*



Dear Sir/Madam

**APPLICATION FOR A PREMISES LICENCE
SHOP AT 2A THE PARADE, RUFFORD DRIVE, WHITEFIELD M45 8PL**

As you may be aware, I have recently taken over the shop and have applied to the Council for a premises licence to sell some alcohol 7am to 11pm daily.

The shop will continue to be a general convenience store/post office selling a wide range of goods including newspapers, magazines, bread, milk, sweets, dairy, soft drinks, cigarettes, etc. The alcohol sales would just be a part of the overall buisness.

The law requires licensed premises to promote the 4 licensing objectives which are; the prevention of crime and disorder, public safety, prevention of public nuisance and the protection of children from harm.

My application shows all the steps that I would take to promote these objectives including CCTV, regular staff training, Challenge 25 underage sales policy, etc. I attach a copy of my proposed licence conditions for your information. I will do everything I can to make sure that local residents are not in any way disturbed by my shop.

I would be grateful if you would complete the brief form below please. If you have any queries or concerns please don't hesitate to let me know, or contact the Council direct.

Thanks

Lijo Thomas (owner)

To; Bury Council Licensing, 3 Knowsley Place, Duke St, Bury BL9 0EJ

Application for a premises licence – 2a The Parade, Rufford Drive, M45 8PL

I support this application for a premises licence

I wish to object to this application

Comments/reasons (please continue on a separate sheet if necessary)

.....local + affordable.....

NAME ADRII MONTAGUE SIGNED [Signature]

ADDRESS 12 THURSTON CLOSE



Dear Sir/Madam

**APPLICATION FOR A PREMISES LICENCE
SHOP AT 2A THE PARADE, RUFFORD DRIVE, WHITEFIELD M45 8PL**

As you may be aware, I have recently taken over the shop and have applied to the Council for a premises licence to sell some alcohol 7am to 11pm daily.

The shop will continue to be a general convenience store/post office selling a wide range of goods including newspapers, magazines, bread, milk, sweets, dairy, soft drinks, cigarettes, etc. The alcohol sales would just be a part of the overall buisness.

The law requires licensed premises to promote the 4 licensing objectives which are; the prevention of crime and disorder, public safety, prevention of public nuisance and the protection of children from harm.

My application shows all the steps that I would take to promote these objectives including CCTV, regular staff training, Challenge 25 underage sales policy, etc. I attach a copy of my proposed licence conditions for your information. I will do everything I can to make sure that local residents are not in any way disturbed by my shop.

I would be grateful if you would complete the brief form below please. If you have any queries or concerns please don't hesitate to let me know, or contact the Council direct.

Thanks

Lijo Thomas (owner)

To; Bury Council Licensing, 3 Knowsley Place, Duke St, Bury BL9 0EJ

Application for a premises licence – 2a The Parade, Rufford Drive, M45 8PL

I support this application for a premises licence

I wish to object to this application

Comments/reasons (please continue on a separate sheet if necessary)

.....
.....
.....

NAME STEVE SMITH SIGNED Stephen R. Smith

ADDRESS 6 Alkington Close
Unsworth BURY BL9 8NP



Dear Sir/Madam

**APPLICATION FOR A PREMISES LICENCE
SHOP AT 2A THE PARADE, RUFFORD DRIVE, WHITEFIELD M45 8PL**

As you may be aware, I have recently taken over the shop and have applied to the Council for a premises licence to sell some alcohol 7am to 11pm daily.

The shop will continue to be a general convenience store/post office selling a wide range of goods including newspapers, magazines, bread, milk, sweets, dairy, soft drinks, cigarettes, etc. The alcohol sales would just be a part of the overall buisness.

The law requires licensed premises to promote the 4 licensing objectives which are; the prevention of crime and disorder, public safety, prevention of public nuisance and the protection of children from harm.

My application shows all the steps that I would take to promote these objectives including CCTV, regular staff training, Challenge 25 underage sales policy, etc. I attach a copy of my proposed licence conditions for your information. I will do everything I can to make sure that local residents are not in any way disturbed by my shop.

I would be grateful if you would complete the brief form below please. If you have any queries or concerns please don't hesitate to let me know, or contact the Council direct.

Thanks

Lijo Thomas (owner)

To; Bury Council Licensing, 3 Knowsley Place, Duke St, Bury BL9 0EJ

Application for a premises licence – 2a The Parade, Rufford Drive, M45 8PL

I support this application for a premises licence

I wish to object to this application

Comments/reasons (please continue on a separate sheet if necessary)

.....
.....
.....
.....

NAME Lijo Thomas SIGNED [Signature]

ADDRESS 2A Tms Close, Whitefield M45 8PL



Dear Sir/Madam

**APPLICATION FOR A PREMISES LICENCE
SHOP AT 2A THE PARADE, RUFFORD DRIVE, WHITEFIELD M45 8PL**

As you may be aware, I have recently taken over the shop and have applied to the Council for a premises licence to sell some alcohol 7am to 11pm daily.

The shop will continue to be a general convenience store/post office selling a wide range of goods including newspapers, magazines, bread, milk, sweets, dairy, soft drinks, cigarettes, etc. The alcohol sales would just be a part of the overall buisness.

The law requires licensed premises to promote the 4 licensing objectives which are; the prevention of crime and disorder, public safety, prevention of public nuisance and the protection of children from harm.

My application shows all the steps that I would take to promote these objectives including CCTV, regular staff training, Challenge 25 underage sales policy, etc. I attach a copy of my proposed licence conditions for your information. I will do everything I can to make sure that local residents are not in any way disturbed by my shop.

I would be grateful if you would complete the brief form below please. If you have any queries or concerns please don't hesitate to let me know, or contact the Council direct.

Thanks

Lijo Thomas (owner)

To; Bury Council Licensing, 3 Knowsley Place, Duke St, Bury BL9 0EJ

Application for a premises licence – 2a The Parade, Rufford Drive, M45 8PL

I support this application for a premises licence

I wish to object to this application

Comments/reasons (please continue on a separate sheet if necessary)

.....
.....
.....

NAME DAVID CALDER SIGNED

ADDRESS 100 HEATHFIELD ROAD

Dear Sir/Madam

**APPLICATION FOR A PREMISES LICENCE
SHOP AT 2A THE PARADE, RUFFORD DRIVE, WHITEFIELD M45 8PL**

As you may be aware, I have recently taken over the shop and have applied to the Council for a premises licence to sell some alcohol 7am to 11pm daily.

The shop will continue to be a general convenience store/post office selling a wide range of goods including newspapers, magazines, bread, milk, sweets, dairy, soft drinks, cigarettes, etc. The alcohol sales would just be a part of the overall buisness.

The law requires licensed premises to promote the 4 licensing objectives which are; the prevention of crime and disorder, public safety, prevention of public nuisance and the protection of children from harm.

My application shows all the steps that I would take to promote these objectives including CCTV, regular staff training, Challenge 25 underage sales policy, etc. I attach a copy of my proposed licence conditions for your information. I will do everything I can to make sure that local residents are not in any way disturbed by my shop.

I would be grateful if you would complete the brief form below please. If you have any queries or concerns please don't hesitate to let me know, or contact the Council direct.

Thanks

Lijo Thomas (owner)

To; Bury Council Licensing, 3 Knowsley Place, Duke St, Bury BL9 0EJ

Application for a premises licence – 2a The Parade, Rufford Drive, M45 8PL

I support this application for a premises licence

I wish to object to this application

Comments/reasons (please continue on a separate sheet if necessary)

.....
.....
.....
.....

NAME Holly SIGNED..... [Signature]

ADDRESS..... 374 Hollins Lane Whitefield

Dear Sir/Madam

**APPLICATION FOR A PREMISES LICENCE
SHOP AT 2A THE PARADE, RUFFORD DRIVE, WHITEFIELD M45 8PL**

As you may be aware, I have recently taken over the shop and have applied to the Council for a premises licence to sell some alcohol 7am to 11pm daily.

The shop will continue to be a general convenience store/post office selling a wide range of goods including newspapers, magazines, bread, milk, sweets, dairy, soft drinks, cigarettes, etc. The alcohol sales would just be a part of the overall buisness.

The law requires licensed premises to promote the 4 licensing objectives which are; the prevention of crime and disorder, public safety, prevention of public nuisance and the protection of children from harm.

My application shows all the steps that I would take to promote these objectives including CCTV, regular staff training, Challenge 25 underage sales policy, etc. I attach a copy of my proposed licence conditions for your information. I will do everything I can to make sure that local residents are not in any way disturbed by my shop.

I would be grateful if you would complete the brief form below please. If you have any queries or concerns please don't hesitate to let me know, or contact the Council direct.

Thanks

Lijo Thomas (owner)

To; Bury Council Licensing, 3 Knowsley Place, Duke St, Bury BL9 0EJ

Application for a premises licence – 2a The Parade, Rufford Drive, M45 8PL

I support this application for a premises licence

I wish to object to this application

Comments/reasons (please continue on a separate sheet if necessary)

.....helpfull + friendly.....
.....
.....

NAME Katie Eacough SIGNED K Eacough

ADDRESS ~~17~~ 3, 74 Hollins Lane

Dear Sir/Madam

**APPLICATION FOR A PREMISES LICENCE
SHOP AT 2A THE PARADE, RUFFORD DRIVE, WHITEFIELD M45 8PL**

As you may be aware, I have recently taken over the shop and have applied to the Council for a premises licence to sell some alcohol 7am to 11pm daily.

The shop will continue to be a general convenience store/post office selling a wide range of goods including newspapers, magazines, bread, milk, sweets, dairy, soft drinks, cigarettes, etc. The alcohol sales would just be a part of the overall business.

The law requires licensed premises to promote the 4 licensing objectives which are; the prevention of crime and disorder, public safety, prevention of public nuisance and the protection of children from harm.

My application shows all the steps that I would take to promote these objectives including CCTV, regular staff training, Challenge 25 underage sales policy, etc. I attach a copy of my proposed licence conditions for your information. I will do everything I can to make sure that local residents are not in any way disturbed by my shop.

I would be grateful if you would complete the brief form below please. If you have any queries or concerns please don't hesitate to let me know, or contact the Council direct.

Thanks

Lijo Thomas (owner)

To; Bury Council Licensing, 3 Knowsley Place, Duke St, Bury BL9 0EJ

Application for a premises licence – 2a The Parade, Rufford Drive, M45 8PL

I support this application for a premises licence

I wish to object to this application

Comments/reasons (please continue on a separate sheet if necessary)

.....
.....
.....

NAME Daniel Butler SIGNED [Signature]
ADDRESS 75 Market Avenue M45 8PL

Dear Sir/Madam

**APPLICATION FOR A PREMISES LICENCE
SHOP AT 2A THE PARADE, RUFFORD DRIVE, WHITEFIELD M45 8PL**

As you may be aware, I have recently taken over the shop and have applied to the Council for a premises licence to sell some alcohol 7am to 11pm daily.

The shop will continue to be a general convenience store/post office selling a wide range of goods including newspapers, magazines, bread, milk, sweets, dairy, soft drinks, cigarettes, etc. The alcohol sales would just be a part of the overall buisness.

The law requires licensed premises to promote the 4 licensing objectives which are; the prevention of crime and disorder, public safety, prevention of public nuisance and the protection of children from harm.

My application shows all the steps that I would take to promote these objectives including CCTV, regular staff training, Challenge 25 underage sales policy, etc. I attach a copy of my proposed licence conditions for your information. I will do everything I can to make sure that local residents are not in any way disturbed by my shop.

I would be grateful if you would complete the brief form below please. If you have any queries or concerns please don't hesitate to let me know, or contact the Council direct.

Thanks

Lijo Thomas (owner)

To; Bury Council Licensing, 3 Knowsley Place, Duke St, Bury BL9 0EJ

Application for a premises licence – 2a The Parade, Rufford Drive, M45 8PL

I support this application for a premises licence

I wish to object to this application

Comments/reasons (please continue on a separate sheet if necessary)

.....

.....

.....

.....

NAME STUART COOMBES SIGNED S. Coombes

ADDRESS 75 MACTON AVE

Dear Sir/Madam

**APPLICATION FOR A PREMISES LICENCE
SHOP AT 2A THE PARADE, RUFFORD DRIVE, WHITEFIELD M45 8PL**

As you may be aware, I have recently taken over the shop and have applied to the Council for a premises licence to sell some alcohol 7am to 11pm daily.

The shop will continue to be a general convenience store/post office selling a wide range of goods including newspapers, magazines, bread, milk, sweets, dairy, soft drinks, cigarettes, etc. The alcohol sales would just be a part of the overall buisness.

The law requires licensed premises to promote the 4 licensing objectives which are; the prevention of crime and disorder, public safety, prevention of public nuisance and the protection of children from harm.

My application shows all the steps that I would take to promote these objectives including CCTV, regular staff training, Challenge 25 underage sales policy, etc. I attach a copy of my proposed licence conditions for your information. I will do everything I can to make sure that local residents are not in any way disturbed by my shop.

I would be grateful if you would complete the brief form below please. If you have any queries or concerns please don't hesitate to let me know, or contact the Council direct.

Thanks

Lijo Thomas (owner)

To; Bury Council Licensing, 3 Knowsley Place, Duke St, Bury BL9 0EJ

Application for a premises licence – 2a The Parade, Rufford Drive, M45 8PL

I support this application for a premises licence

I wish to object to this application

Comments/reasons (please continue on a separate sheet if necessary)

.....
.....
.....
.....

NAME D. BONDERS SIGNED D. Comby
ADDRESS 73 MALTON AVE

Dear Sir/Madam

**APPLICATION FOR A PREMISES LICENCE
SHOP AT 2A THE PARADE, RUFFORD DRIVE, WHITEFIELD M45 8PL**

As you may be aware, I have recently taken over the shop and have applied to the Council for a premises licence to sell some alcohol 7am to 11pm daily.

The shop will continue to be a general convenience store/post office selling a wide range of goods including newspapers, magazines, bread, milk, sweets, dairy, soft drinks, cigarettes, etc. The alcohol sales would just be a part of the overall business.

The law requires licensed premises to promote the 4 licensing objectives which are; the prevention of crime and disorder, public safety, prevention of public nuisance and the protection of children from harm.

My application shows all the steps that I would take to promote these objectives including CCTV, regular staff training, Challenge 25 underage sales policy, etc. I attach a copy of my proposed licence conditions for your information. I will do everything I can to make sure that local residents are not in any way disturbed by my shop.

I would be grateful if you would complete the brief form below please. If you have any queries or concerns please don't hesitate to let me know, or contact the Council direct.

Thanks

Lijo Thomas (owner)

To; Bury Council Licensing, 3 Knowsley Place, Duke St, Bury BL9 0EJ

Application for a premises licence – 2a The Parade, Rufford Drive, M45 8PL

I support this application for a premises licence

I wish to object to this application

Comments/reasons (please continue on a separate sheet if necessary)

.....
The other shop ~~is~~ is too
expensive
.....
.....

NAME STUART MEDCALF

SIGNED 

ADDRESS 73 MALTON AVENUE, WHITEFIELD



Dear Sir/Madam

**APPLICATION FOR A PREMISES LICENCE
SHOP AT 2A THE PARADE, RUFFORD DRIVE, WHITEFIELD M45 8PL**

As you may be aware, I have recently taken over the shop and have applied to the Council for a premises licence to sell some alcohol 7am to 11pm daily.

The shop will continue to be a general convenience store/post office selling a wide range of goods including newspapers, magazines, bread, milk, sweets, dairy, soft drinks, cigarettes, etc. The alcohol sales would just be a part of the overall buisness.

The law requires licensed premises to promote the 4 licensing objectives which are; the prevention of crime and disorder, public safety, prevention of public nuisance and the protection of children from harm.

My application shows all the steps that I would take to promote these objectives including CCTV, regular staff training, Challenge 25 underage sales policy, etc. I attach a copy of my proposed licence conditions for your information. I will do everything I can to make sure that local residents are not in any way disturbed by my shop.

I would be grateful if you would complete the brief form below please. If you have any queries or concerns please don't hesitate to let me know, or contact the Council direct.

Thanks

Lijo Thomas (owner)

To; Bury Council Licensing, 3 Knowsley Place, Duke St, Bury BL9 0EJ

Application for a premises licence – 2a The Parade, Rufford Drive, M45 8PL

I support this application for a premises licence

I wish to object to this application

Comments/reasons (please continue on a separate sheet if necessary)

The guys are nicer in this shop

NAME Craig Wilson SIGNED C.P. Wilson

ADDRESS 30 wellhead close

Whitefield

Dear Sir/Madam

**APPLICATION FOR A PREMISES LICENCE
SHOP AT 2A THE PARADE, RUFFORD DRIVE, WHITEFIELD M45 8PL**

As you may be aware, I have recently taken over the shop and have applied to the Council for a premises licence to sell some alcohol 7am to 11pm daily.

The shop will continue to be a general convenience store/post office selling a wide range of goods including newspapers, magazines, bread, milk, sweets, dairy, soft drinks, cigarettes, etc. The alcohol sales would just be a part of the overall buisness.

The law requires licensed premises to promote the 4 licensing objectives which are; the prevention of crime and disorder, public safety, prevention of public nuisance and the protection of children from harm.

My application shows all the steps that I would take to promote these objectives including CCTV, regular staff training, Challenge 25 underage sales policy, etc. I attach a copy of my proposed licence conditions for your information. I will do everything I can to make sure that local residents are not in any way disturbed by my shop.

I would be grateful if you would complete the brief form below please. If you have any queries or concerns please don't hesitate to let me know, or contact the Council direct.

Thanks

Lijo Thomas (owner)

To; Bury Council Licensing, 3 Knowsley Place, Duke St, Bury BL9 0EJ

Application for a premises licence – 2a The Parade, Rufford Drive, M45 8PL

I support this application for a premises licence

I wish to object to this application

Comments/reasons (please continue on a separate sheet if necessary)

.....
a lot cheaper on Groceries, Alchohol
+ Cigarettes
.....
.....

NAME Shaaron Myers SIGNED [Signature]

ADDRESS 30 Welbeck close

WHITEFIELD
M45 8PL



Dear Sir/Madam

**APPLICATION FOR A PREMISES LICENCE
SHOP AT 2A THE PARADE, RUFFORD DRIVE, WHITEFIELD M45 8PL**

As you may be aware, I have recently taken over the shop and have applied to the Council for a premises licence to sell some alcohol 7am to 11pm daily.

The shop will continue to be a general convenience store/post office selling a wide range of goods including newspapers, magazines, bread, milk, sweets, dairy, soft drinks, cigarettes, etc. The alcohol sales would just be a part of the overall buisness.

The law requires licensed premises to promote the 4 licensing objectives which are; the prevention of crime and disorder, public safety, prevention of public nuisance and the protection of children from harm.

My application shows all the steps that I would take to promote these objectives including CCTV, regular staff training, Challenge 25 underage sales policy, etc. I attach a copy of my proposed licence conditions for your information. I will do everything I can to make sure that local residents are not in any way disturbed by my shop.

I would be grateful if you would complete the brief form below please. If you have any queries or concerns please don't hesitate to let me know, or contact the Council direct.

Thanks

Lijo Thomas (owner)

To; Bury Council Licensing, 3 Knowsley Place, Duke St, Bury BL9 0EJ

Application for a premises licence – 2a The Parade, Rufford Drive, M45 8PL

I support this application for a premises licence

I wish to object to this application

Comments/reasons (please continue on a separate sheet if necessary)

..... *So much cheaper than the other shop.*

NAME *Marc Myers* SIGNED *M. Myers*

ADDRESS *30 WELBECK CLOSE*
WHITEFIELD



Dear Sir/Madam

**APPLICATION FOR A PREMISES LICENCE
SHOP AT 2A THE PARADE, RUFFORD DRIVE, WHITEFIELD M45 8PL**

As you may be aware, I have recently taken over the shop and have applied to the Council for a premises licence to sell some alcohol 7am to 11pm daily.

The shop will continue to be a general convenience store/post office selling a wide range of goods including newspapers, magazines, bread, milk, sweets, dairy, soft drinks, cigarettes, etc. The alcohol sales would just be a part of the overall business.

The law requires licensed premises to promote the 4 licensing objectives which are; the prevention of crime and disorder, public safety, prevention of public nuisance and the protection of children from harm.

My application shows all the steps that I would take to promote these objectives including CCTV, regular staff training, Challenge 25 underage sales policy, etc. I attach a copy of my proposed licence conditions for your information. I will do everything I can to make sure that local residents are not in any way disturbed by my shop.

I would be grateful if you would complete the brief form below please. If you have any queries or concerns please don't hesitate to let me know, or contact the Council direct.

Thanks

Lijo Thomas (owner)

To; Bury Council Licensing, 3 Knowsley Place, Duke St, Bury BL9 0EJ

Application for a premises licence – 2a The Parade, Rufford Drive, M45 8PL

I support this application for a premises licence

I wish to object to this application

Comments/reasons (please continue on a separate sheet if necessary)

.....
.....
.....
.....

NAME TOM JO SIGNED [Signature]

ADDRESS 30 WELBECK M45 8PL

This page is intentionally left blank